

图 1 295—01000 机体总成(一)——机体
 Fig.1 295—01000 Cylinder Block Assembly(A)
 —Cylinder block



图 1 295—01000 机体总成 (一) —— 机体
 Fig.1 295—01000 Cylinder Block Assembly (A)
 ——Cylinder block



图 1 295—01000 机体总成(—)——机体
 Fig.1 295—01000 Cylinder Block Assembly(A)
 —Cylinder block

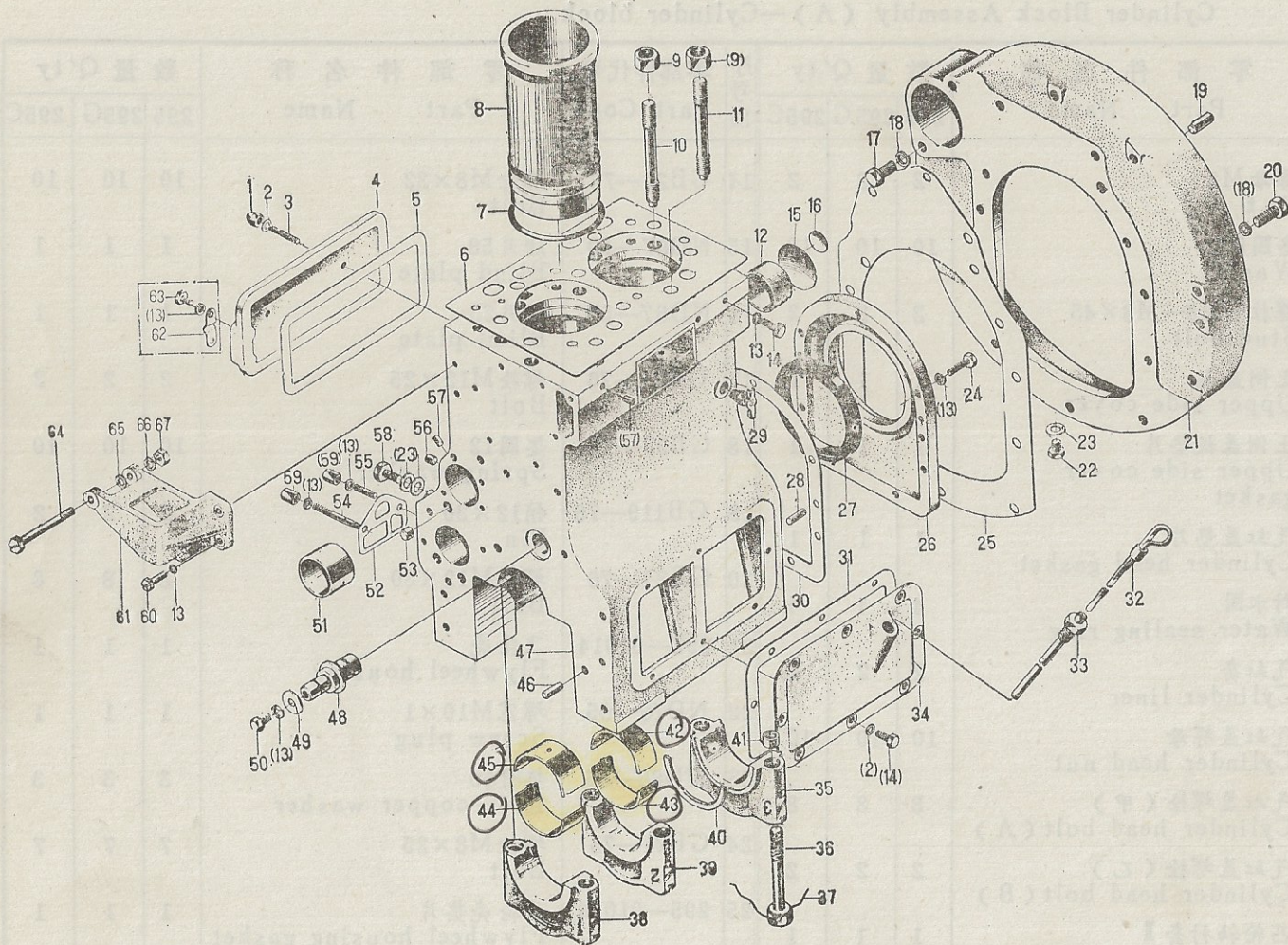

图2 295—01000 机体总成(二) —齿轮室
 Fig.2 295—01000 Cylinder Block Assembly(B)
 —Gear housing

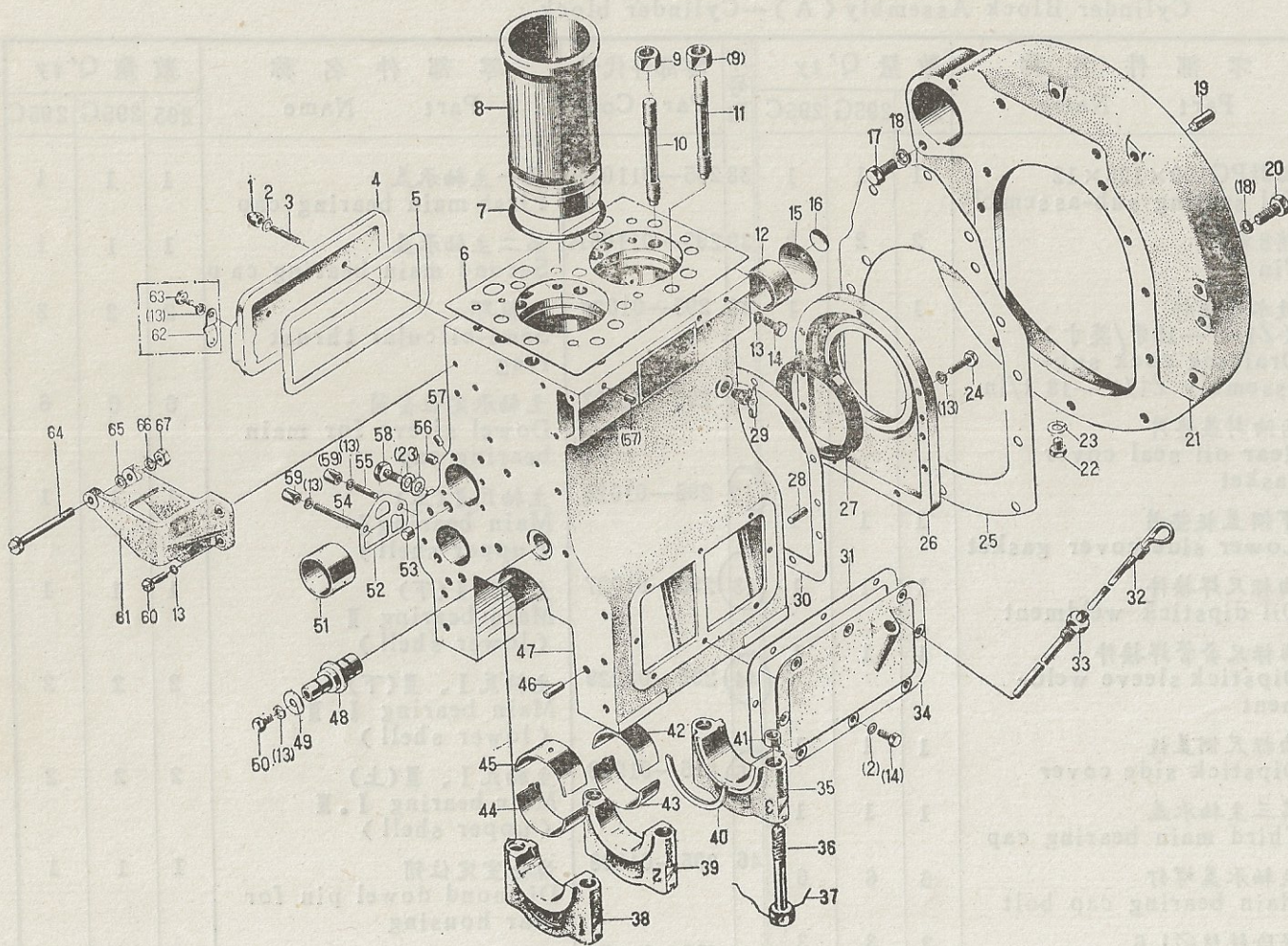

图2 295—01000 机体总成(二) — 齿轮室
 Fig.2 295—01000 Cylinder Block Assembly(B)
 — Gear housing

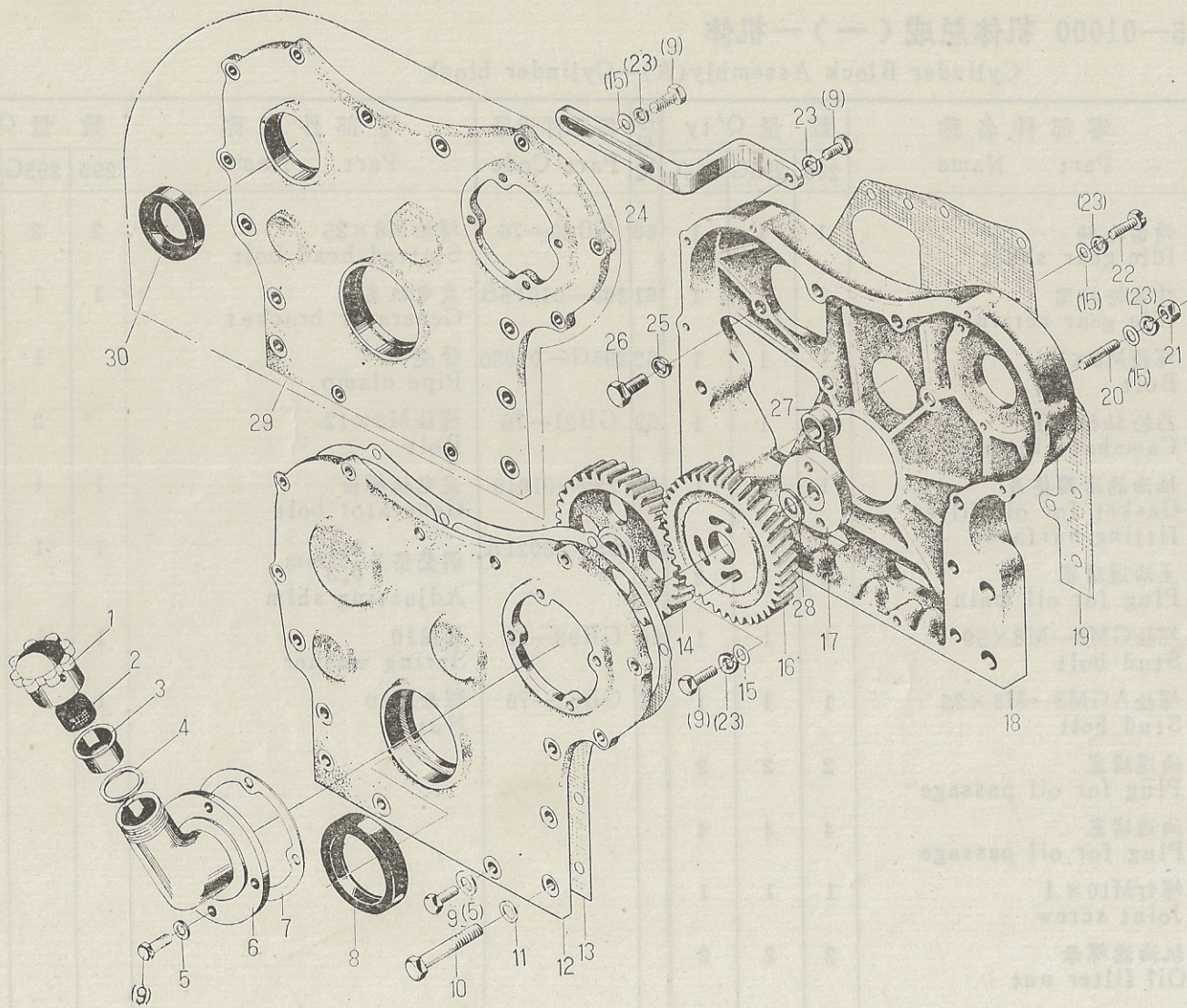

图 4 295—01000 机体总成(四)——前托架(固定型及船用型)
 Fig.4 295-01000 Cylinder Block Assembly (D)
 —Fore supporter (for stationary and marine use)

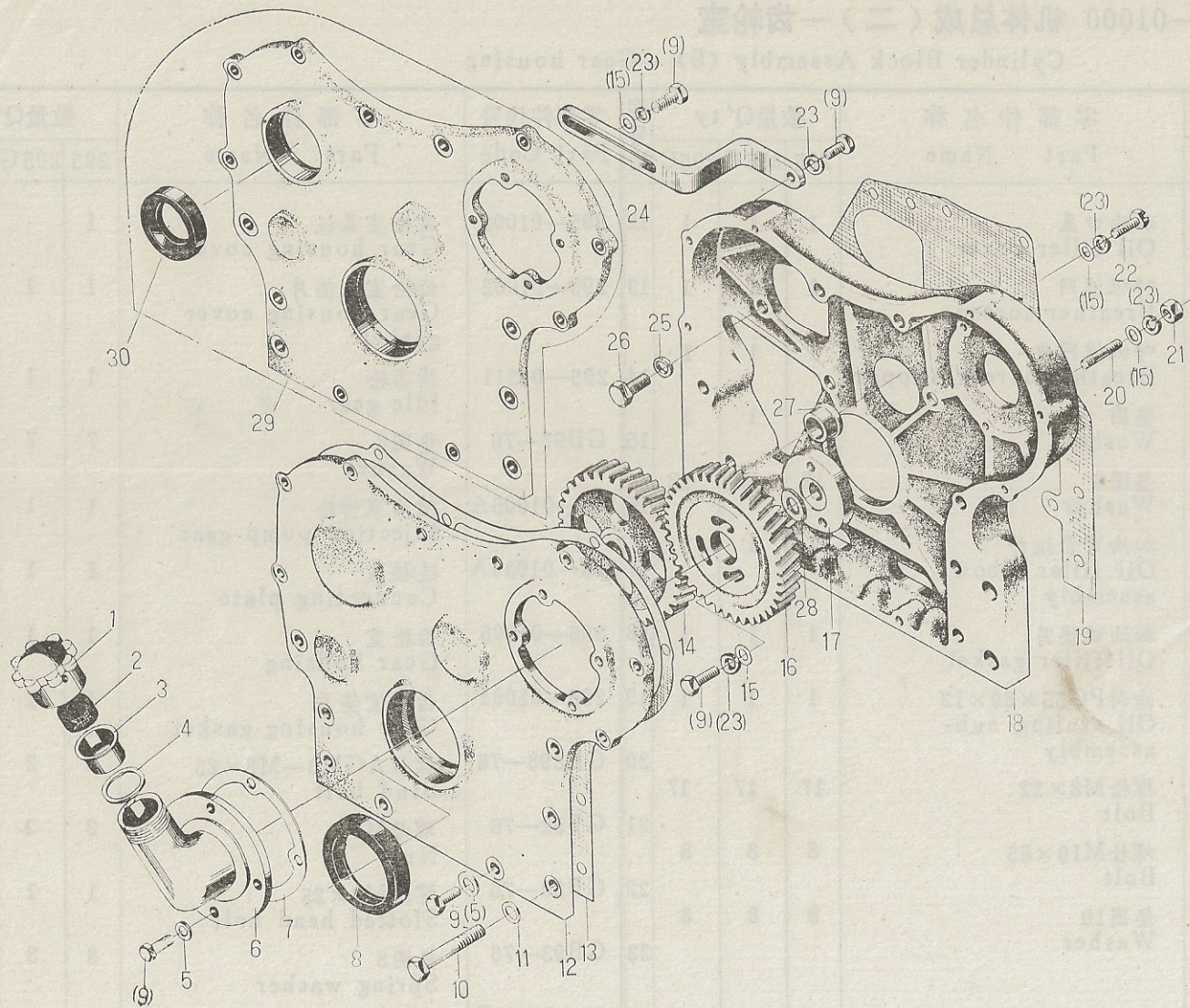

图3 295—01000 机体总成(三)——油底壳
 Fig.3 295-01000 Cylinder Block Assembly (C)
 —Lubricating oil Sump

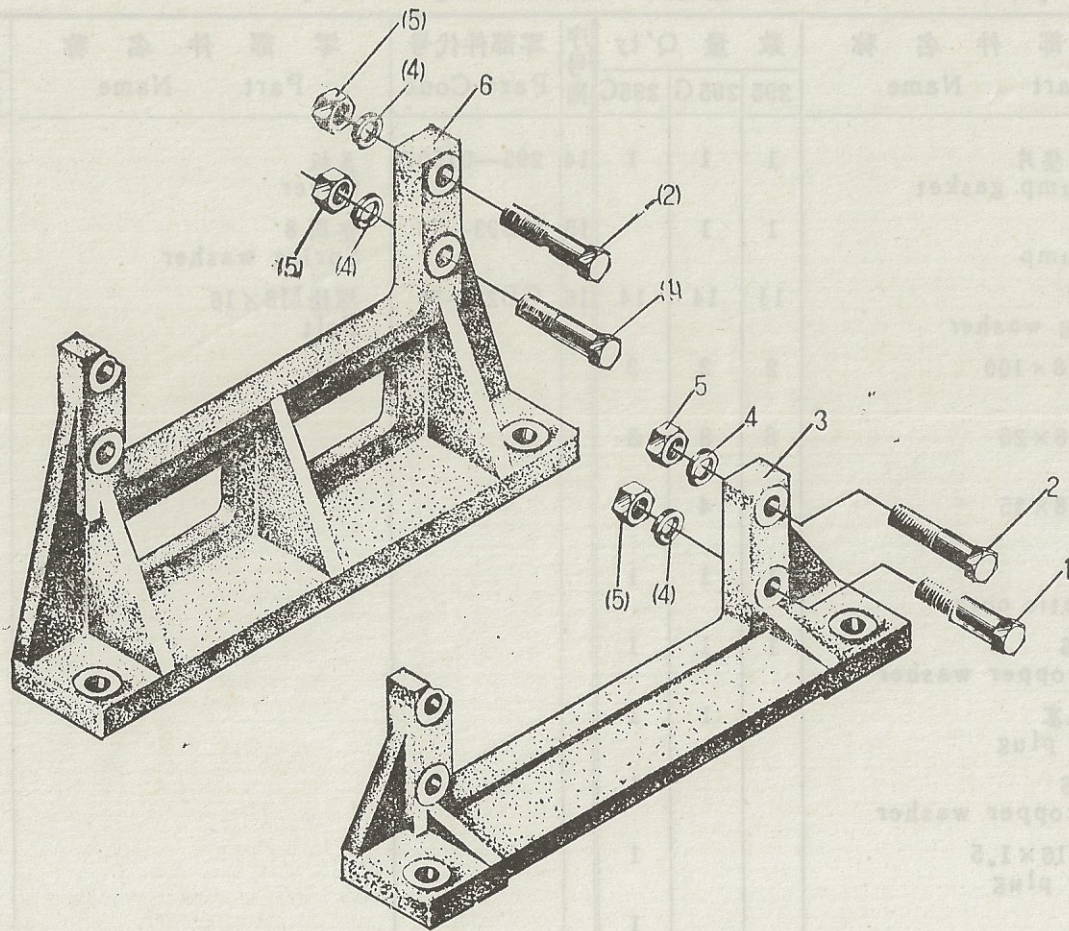

图5 295—02000 凸轮轴总成
Fig.5 295-02000 Camshaft Assembly

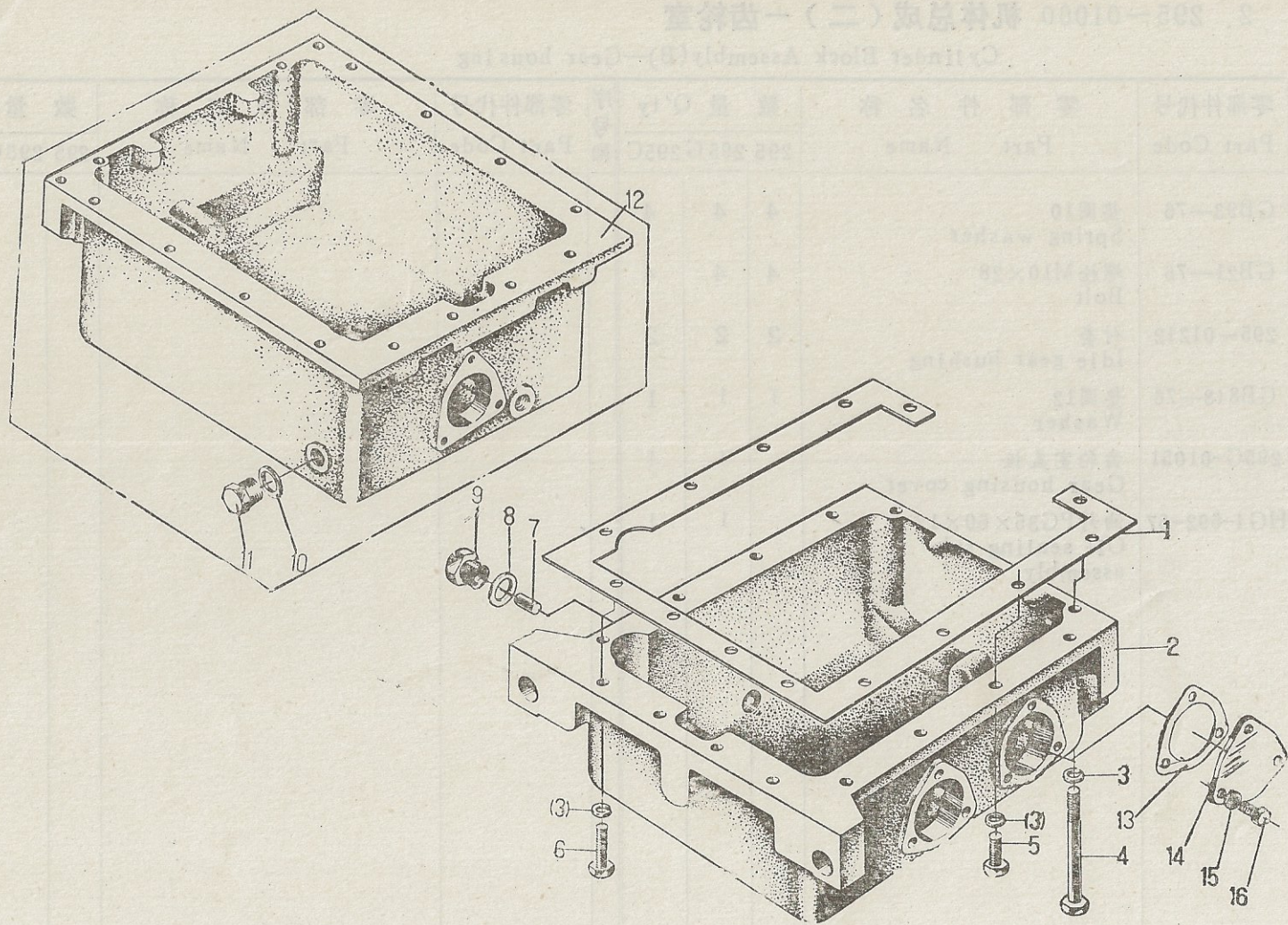

图6 295-03000 气缸盖总成

Fig.6 295-03000 Cylinder Head Assembly

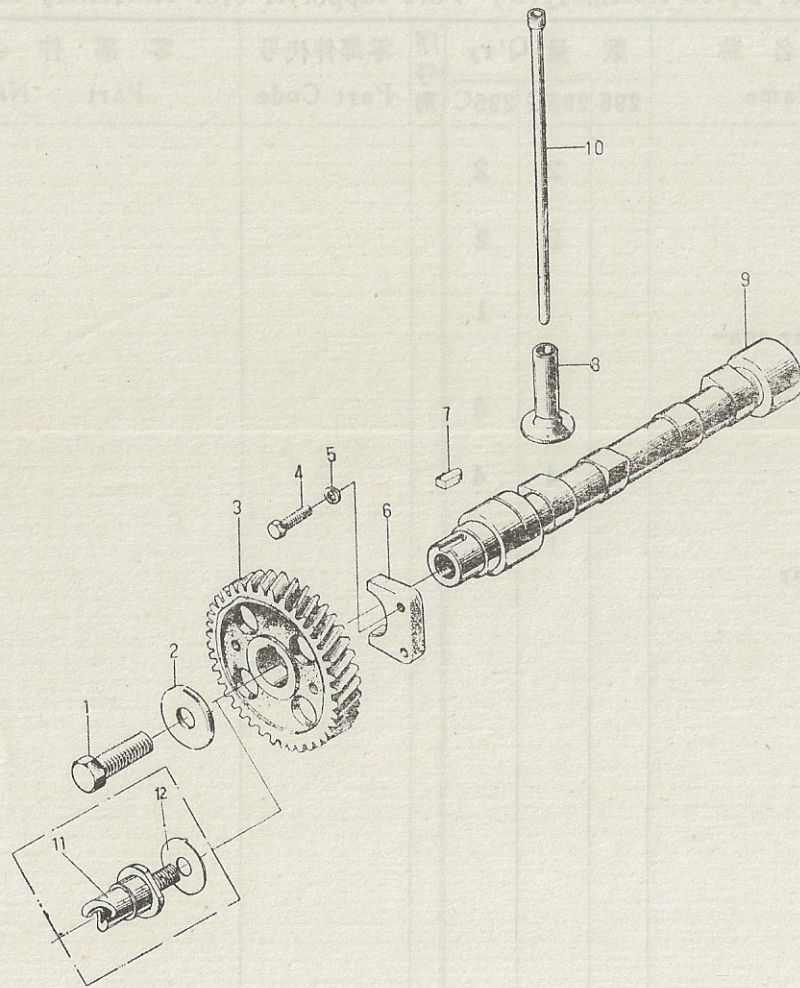

图 6 295-03000 气缸盖总成

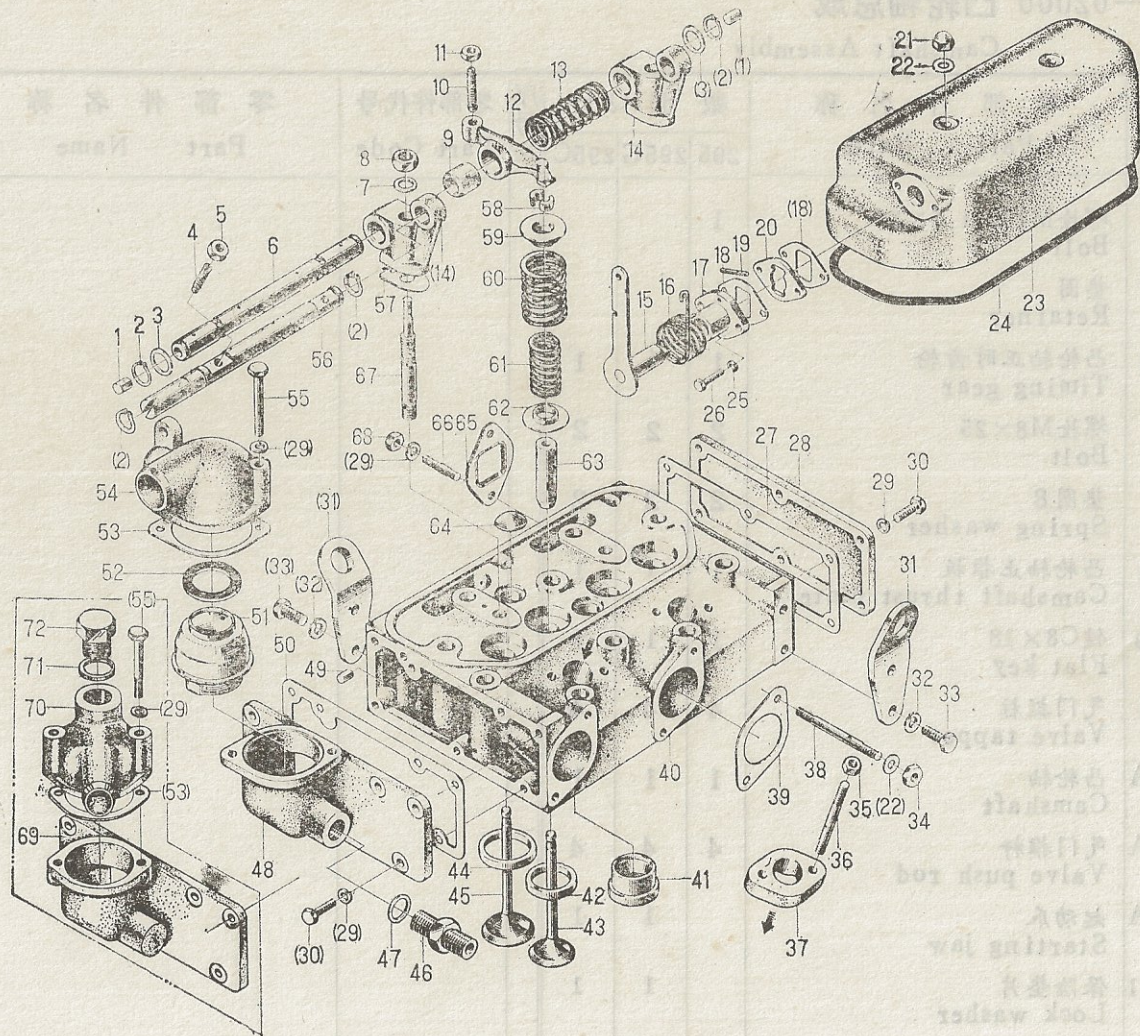
Fig.6 295-03000 Cylinder Head Assembly

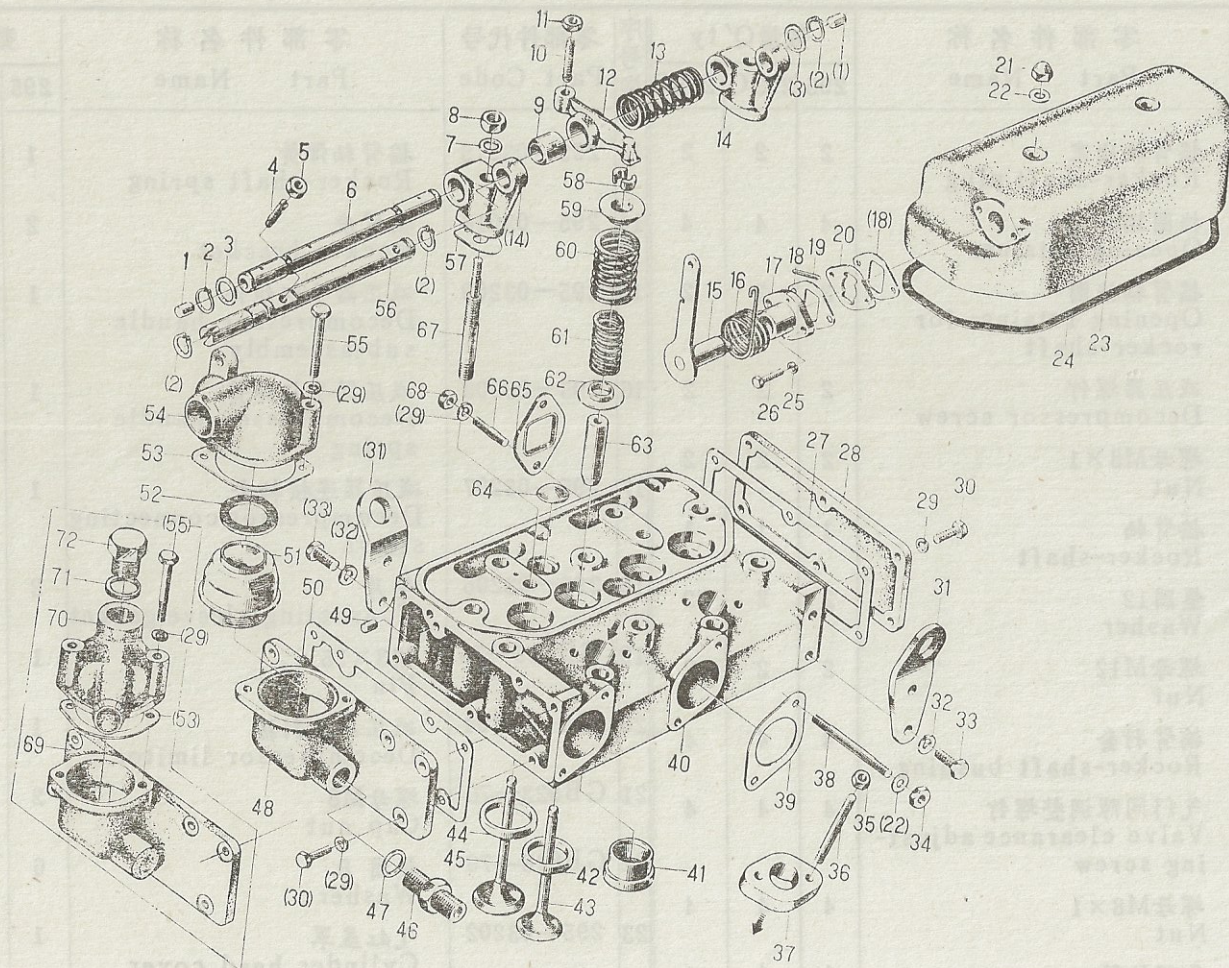

图 6 295—03000 气缸盖总成

Fig.6 295-03000 Cylinder Head Assembly

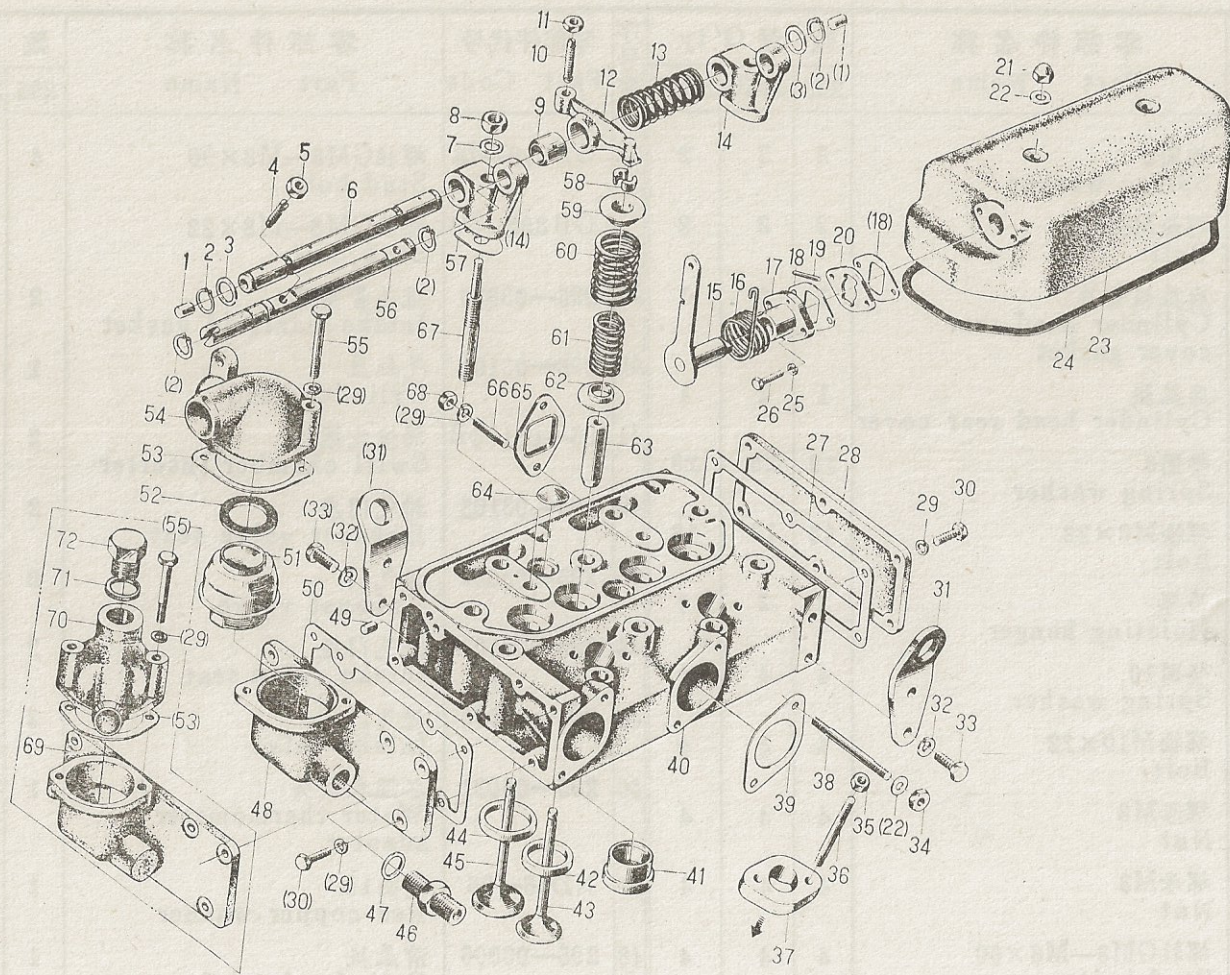

图 7 295-04000 活塞连杆总成

Fig.7 295-04000 Piston And Connecting-rod Assembly

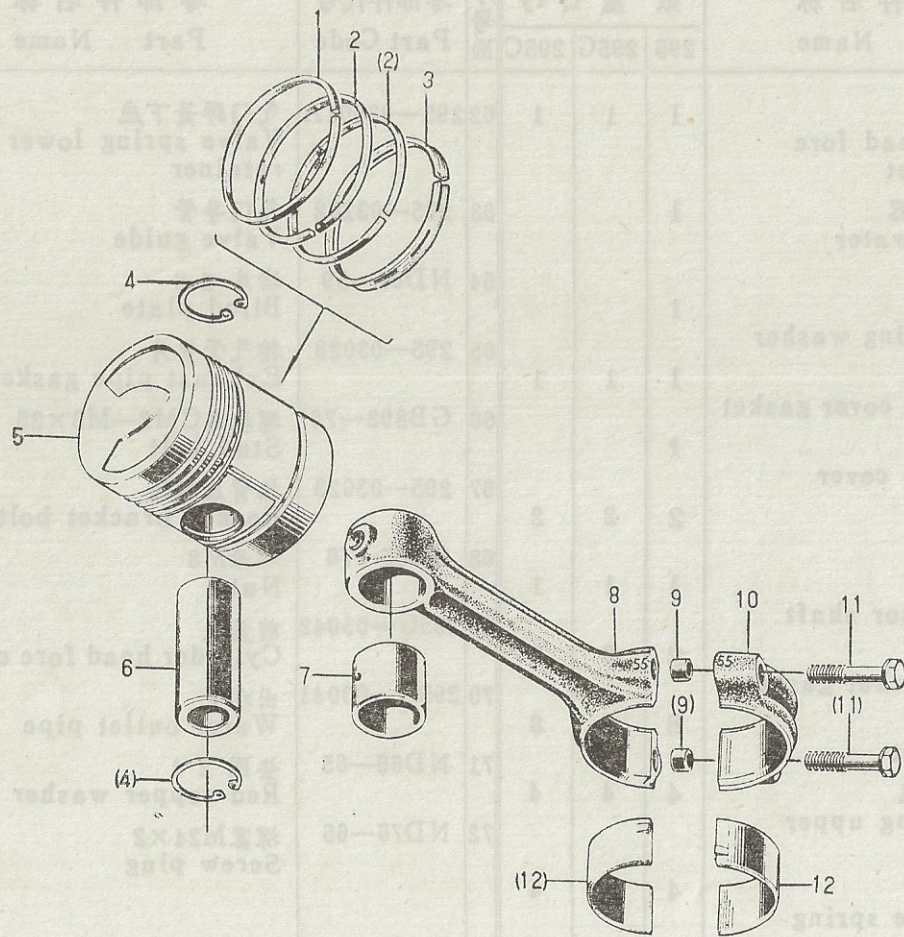

图 8 295—05000 曲轴飞轮总成

Fig.8 295-05000 Crankshaft And Flywheel Assembly



图 9 295—06000A 风扇水泵总成(拖拉机型)
 Fig.9 295-06000A Fan And Water Pump Assembly
 (for tractor use)

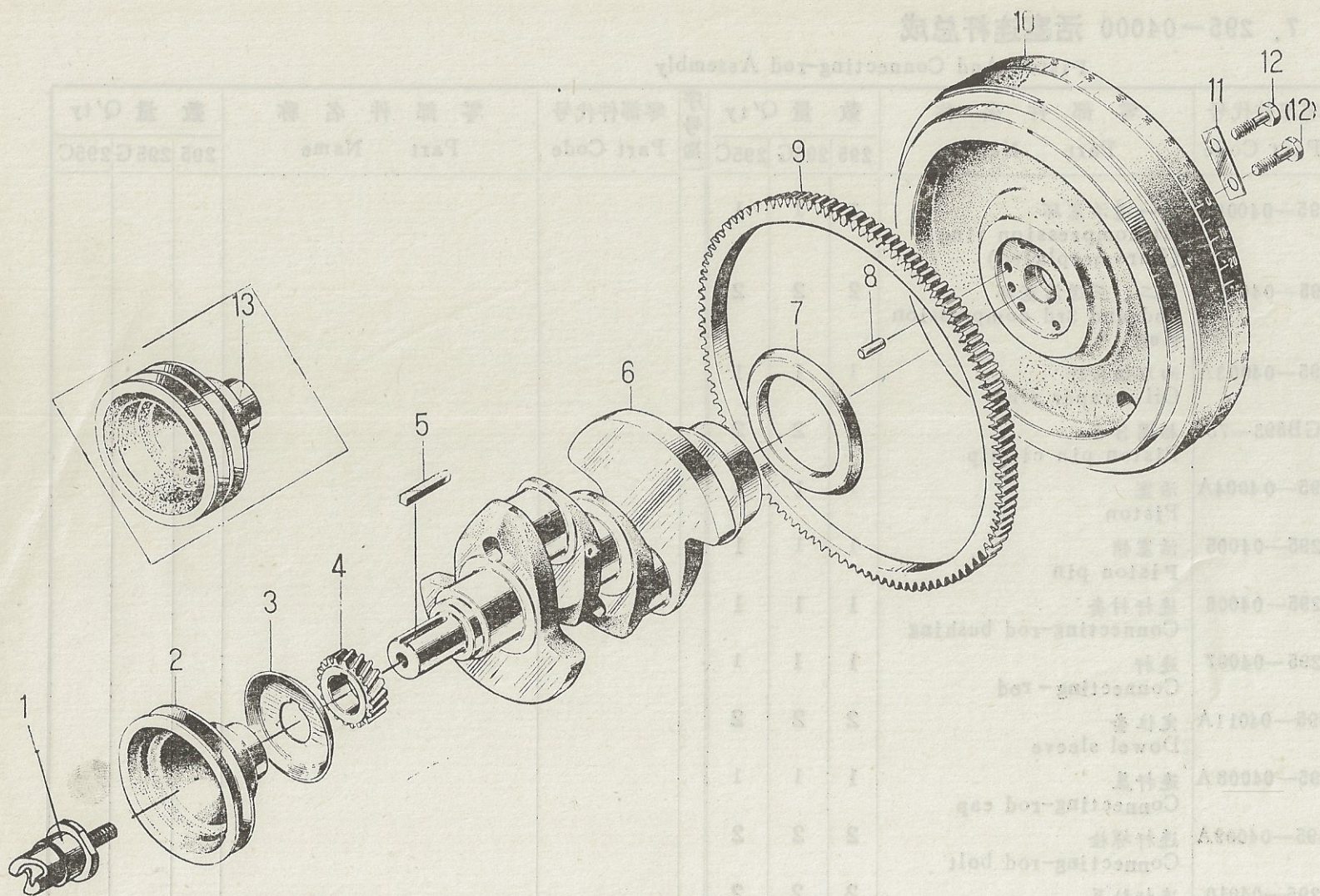

图 9 295—06000A 风扇水泵总成(拖拉机型)
 Fig.9 295-06000A Fan And Water Pump Assembly
 (for tractor use)

0. 295-06000A 水泵总成 (固定型及船用型)

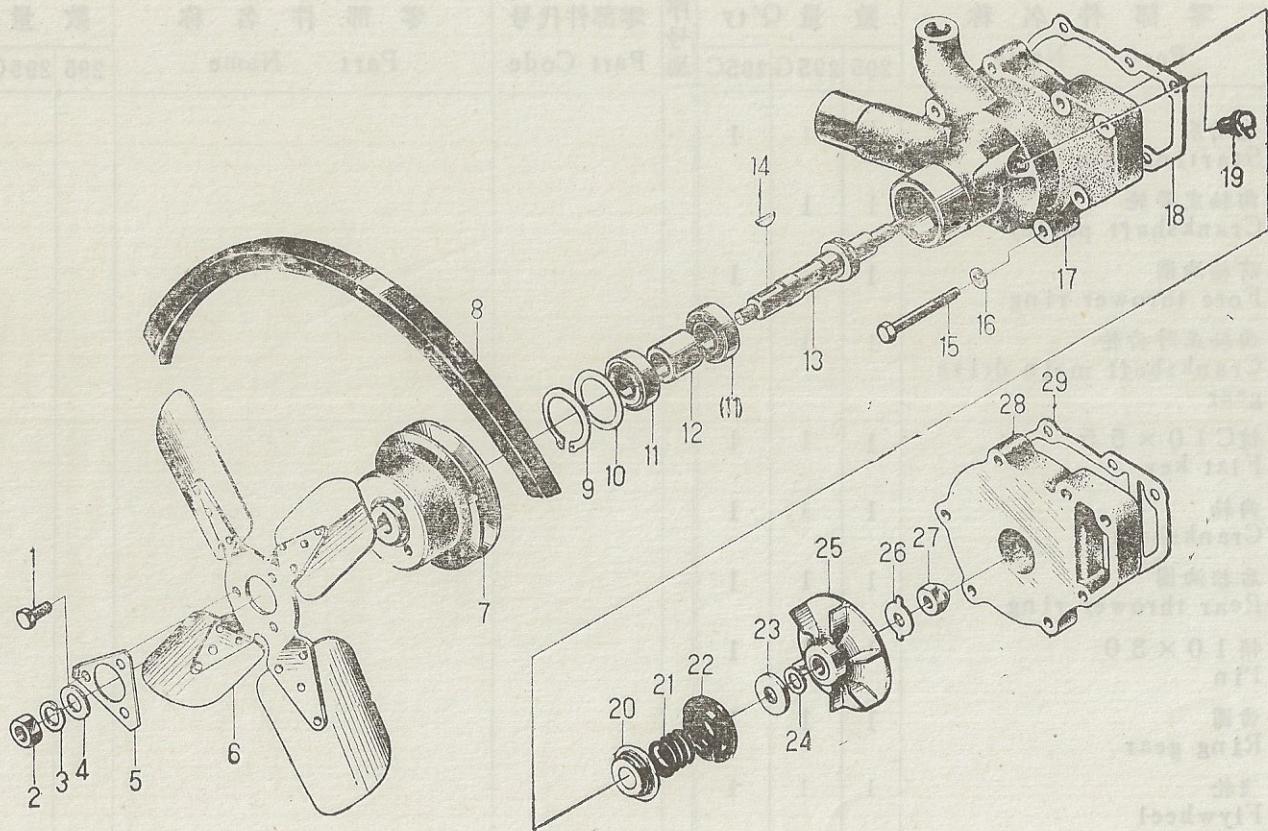
Fig. 10 295G-06000 Water Pump Assembly (for stationary and marine use)

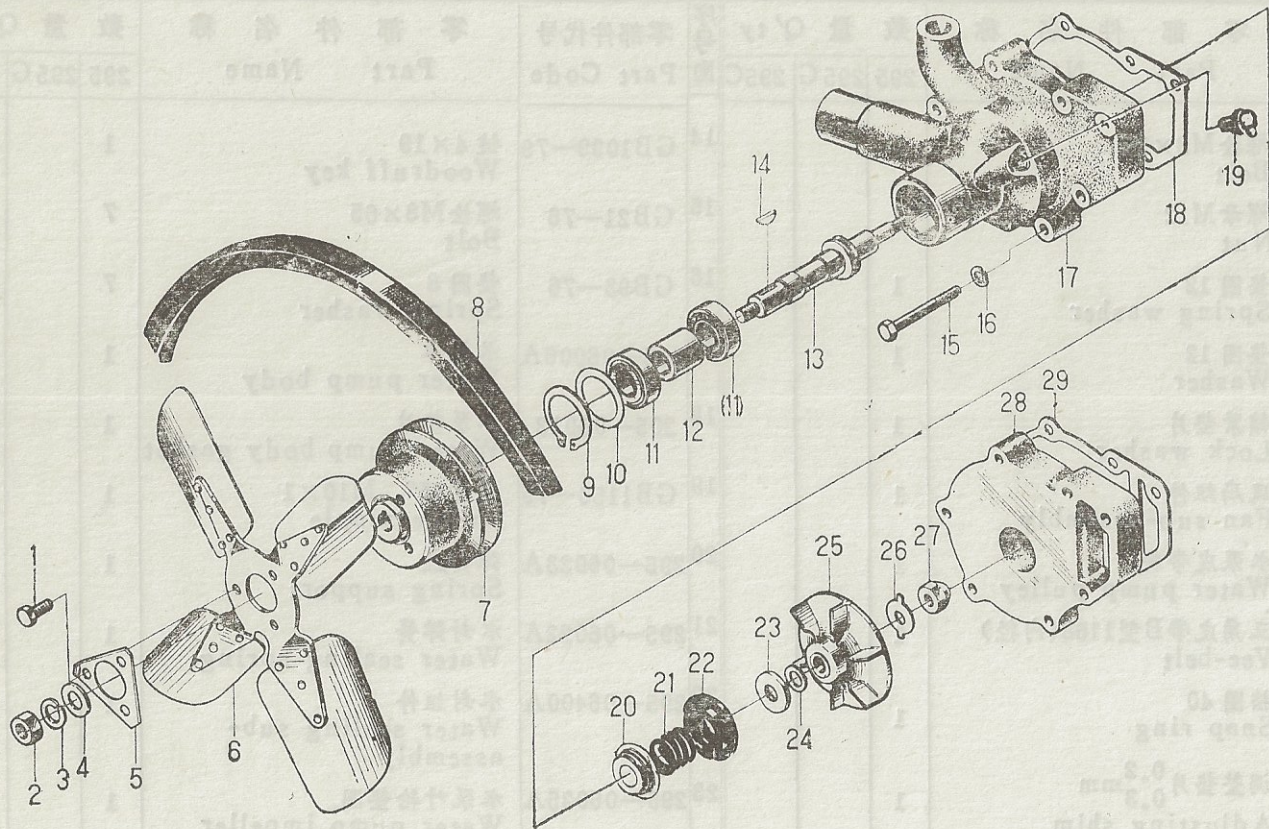

图 10 295G—06000 水泵总成 (固定型及船用型)
Fig.10 295G—06000 Water Pump Assembly
(for stationary and marine use)



图 10 295G—06000 水泵总成(固定型及船用型)
 Fig.10 295G—06000 Water Pump Assembly
 (for stationary and marine use)

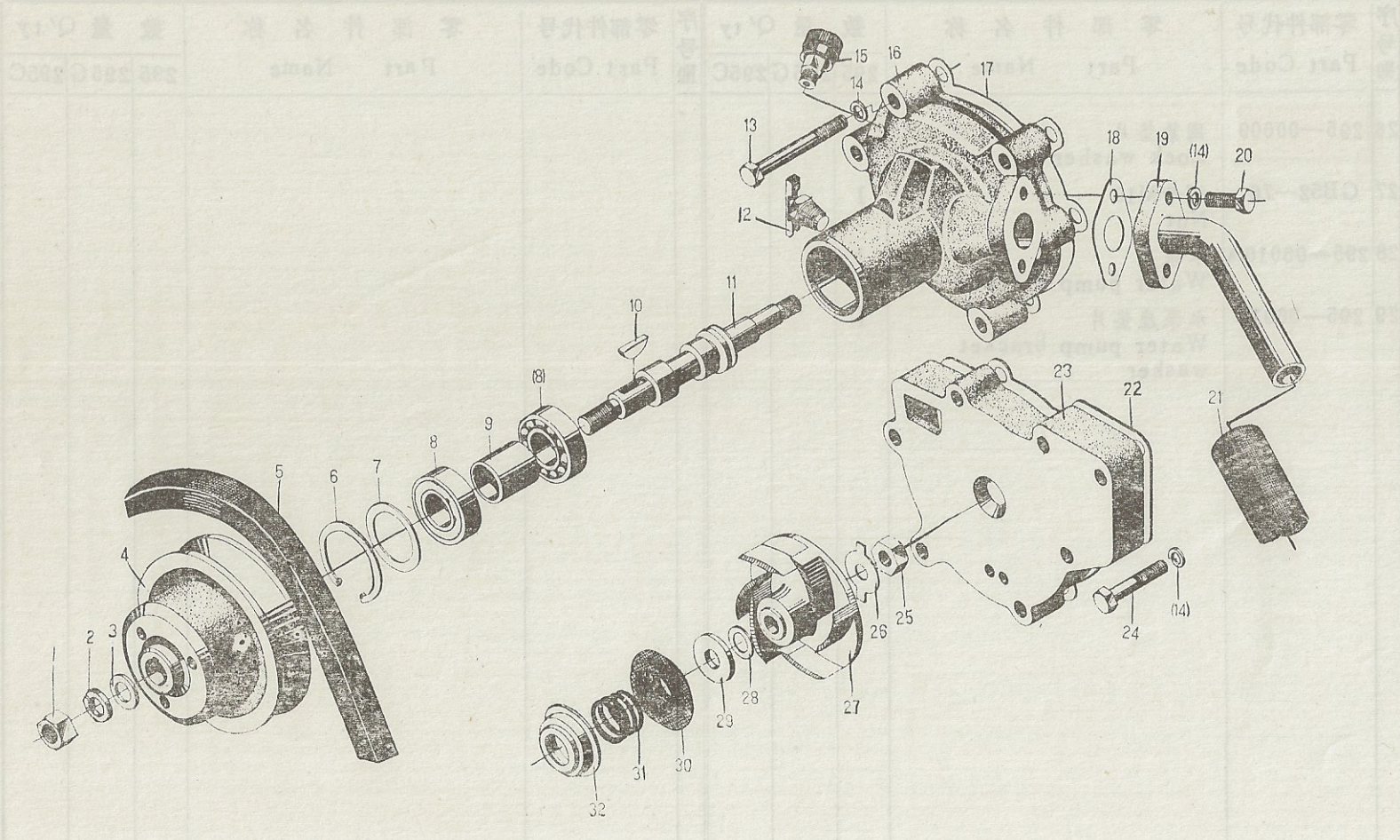

图 11 295—06100A 散热器总成 (拖拉机型)

295—06300 冷却水管路 (拖拉机型)

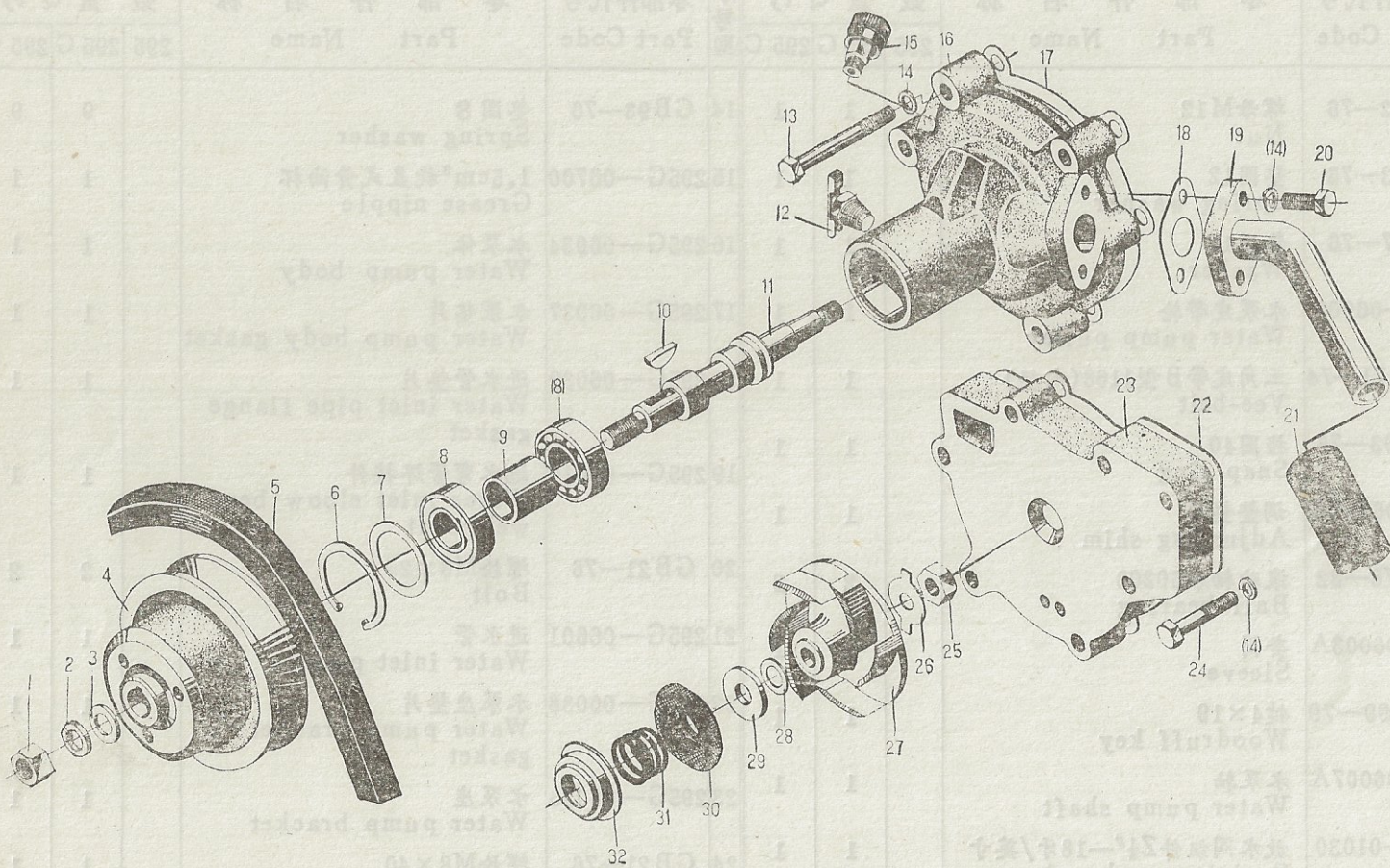
Fig.11 295-06100A Radiator Assembly (for tractor use)

295-06300 Cooling Water Piping (for tractor use)

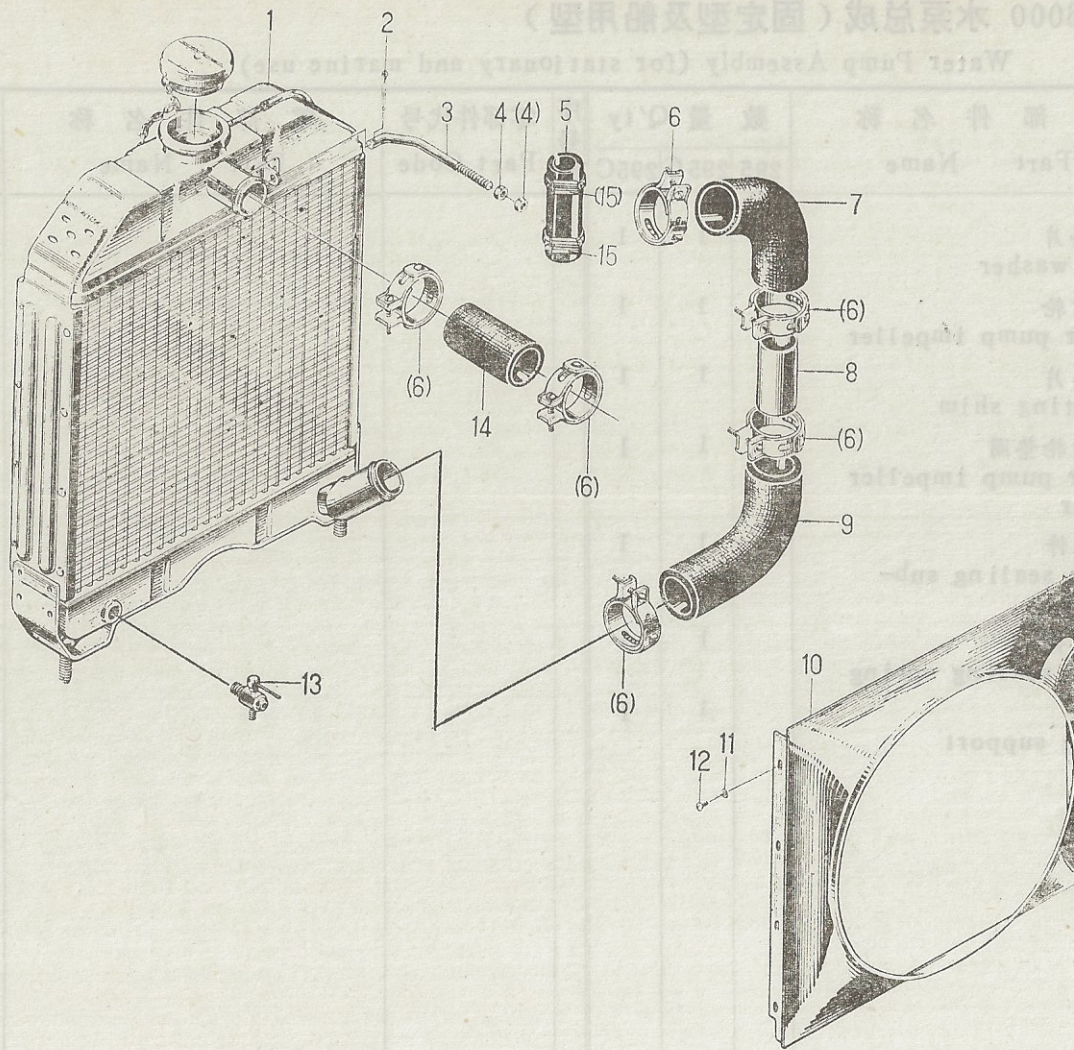
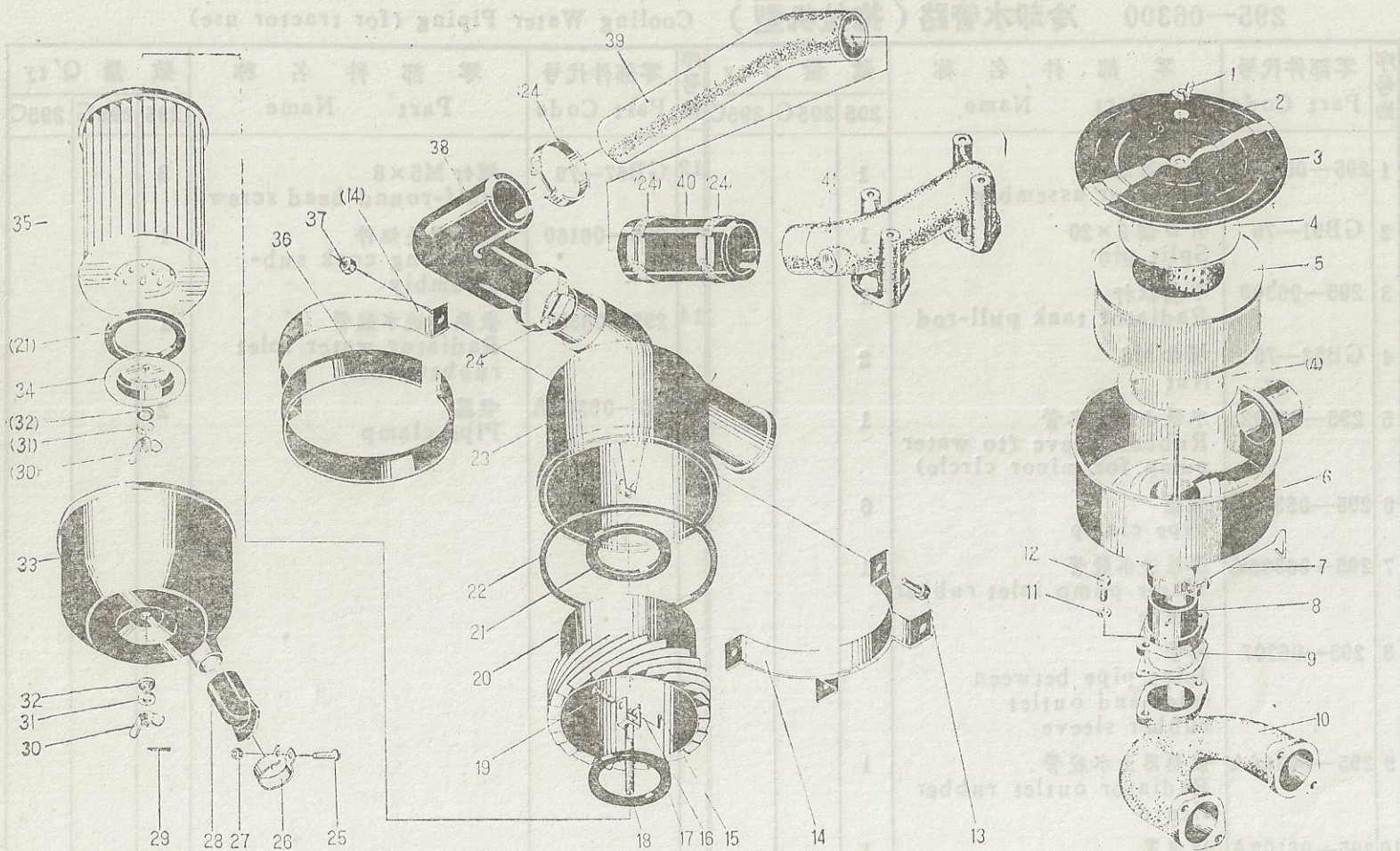

(拖拉机型)

(for tractor use)

图12 295-07000 进气系统(拖拉机型)

295G-07000 进气系统(固定型及船用型)

Fig.12 295-07000 Air Intake System (for tractor use)

295G-07000 Air Intake System (for stationary and marine use)

(固定型及船用型)

(for stationary and marine use)

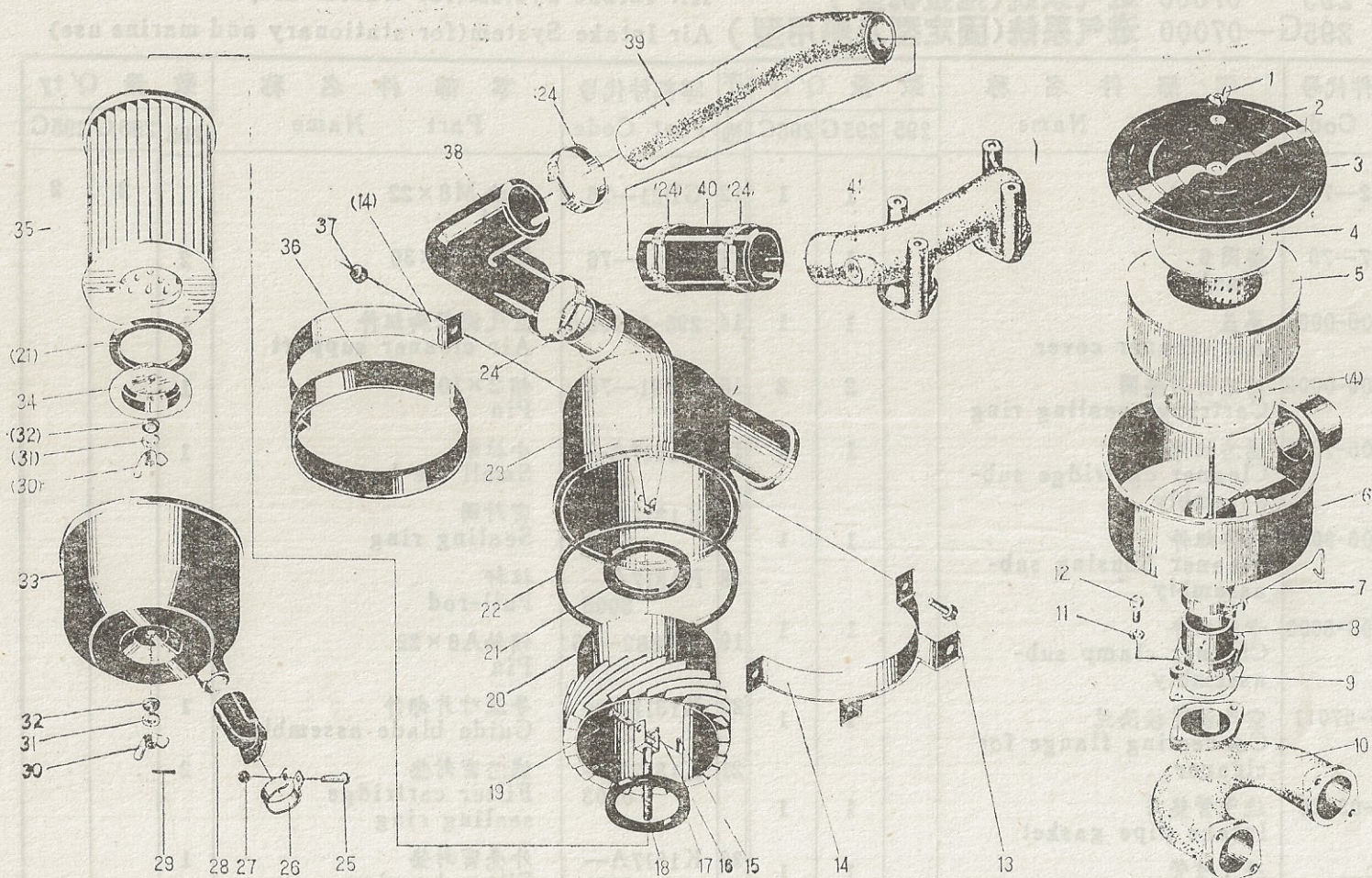

(拖拉机型)

(for tractor use)

图12 295-07000 进气系统(拖拉机型)

295G-07000 进气系统(固定型及船用型)

Fig.12 295-07000 Air Intake System (for tractor use)

295G-07000 Air Intake System (for stationary and marine use)

(固定型及船用型)

(for stationary and marine use)

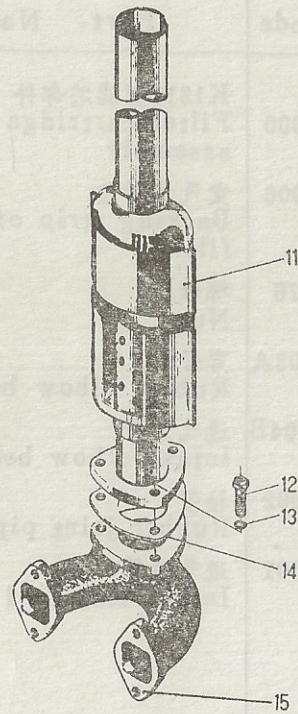

(固定型及船用型)
(for stationary and marine use)

图13 295-08000

排气系统(拖拉机型)

295G-08000 排气系统(固定型及船用型)

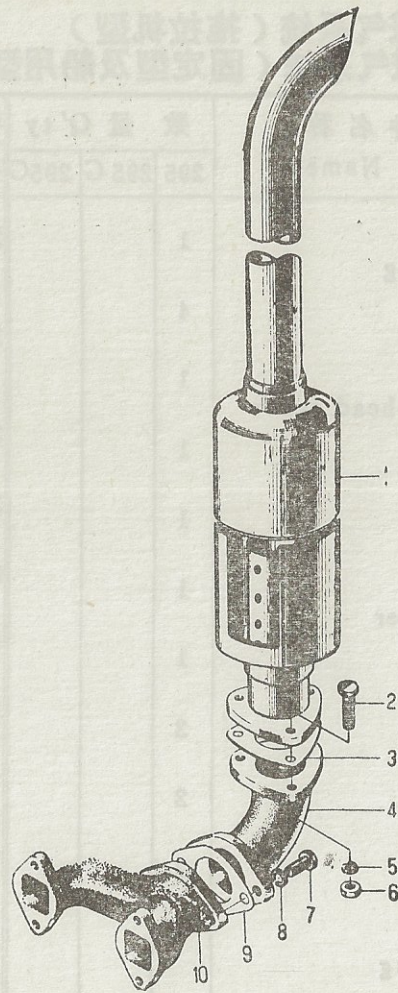

(拖拉机型)

(for tractor use)

Fig.13 295-08000 Exhaust System (for tractor use)
295G-08000 Exhaust System (for stationary and marine use)



图 14 295—09000 润滑系统(一)——机油泵
 Fig.14 295-09000 Lubricating System(A)
 —Lubricating oil pump



图15 295—09000 润滑系统(二)——粗滤器及机油表(拖拉机型及固定型)

Fig.15 295-09000 Lubricating System(B)

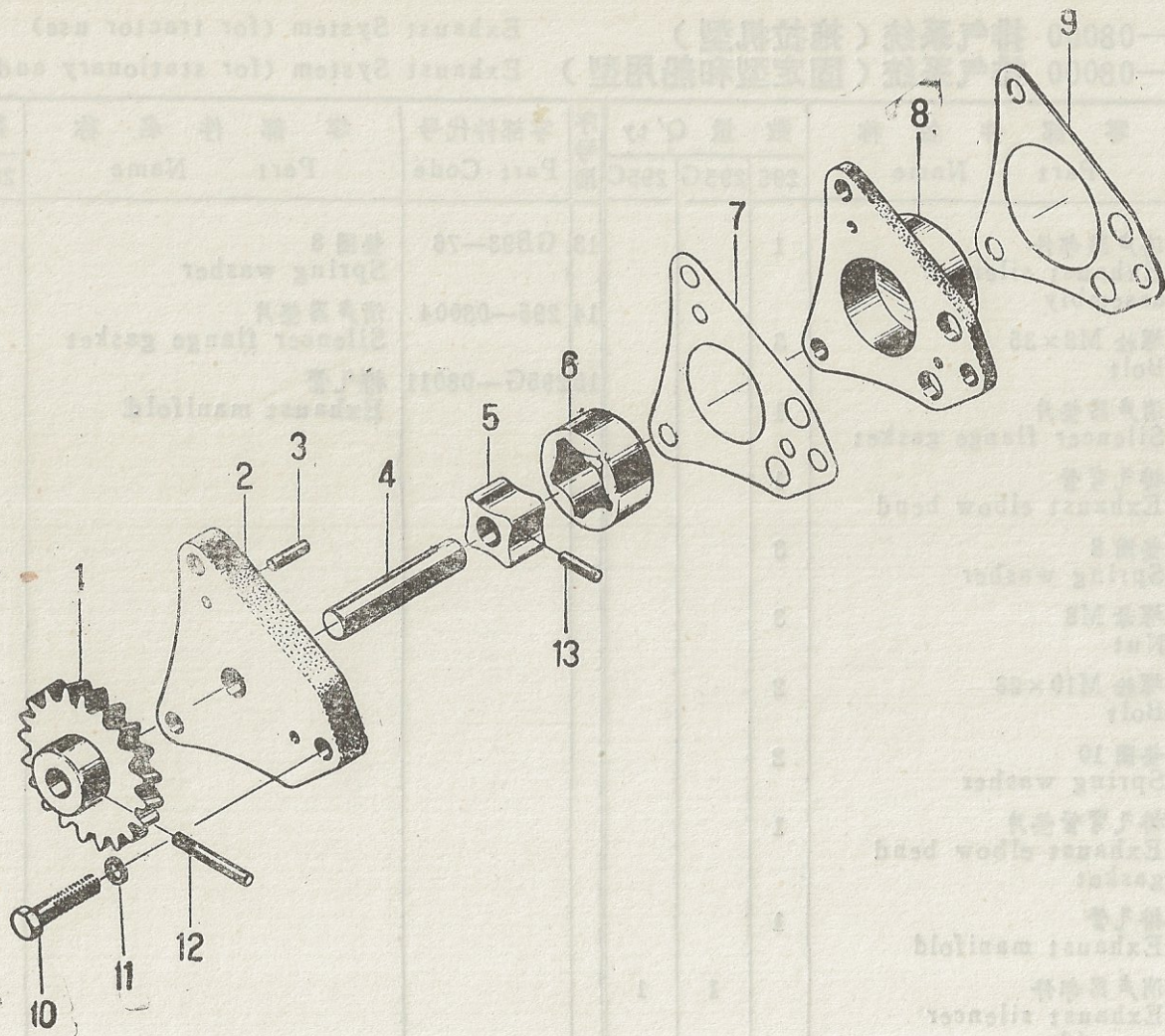
—Oil strainer and pressure gauge
(for tractor and stationary use)

15. 295-09000 潤滑系統(三)——粗濾器及機油表(船用型)

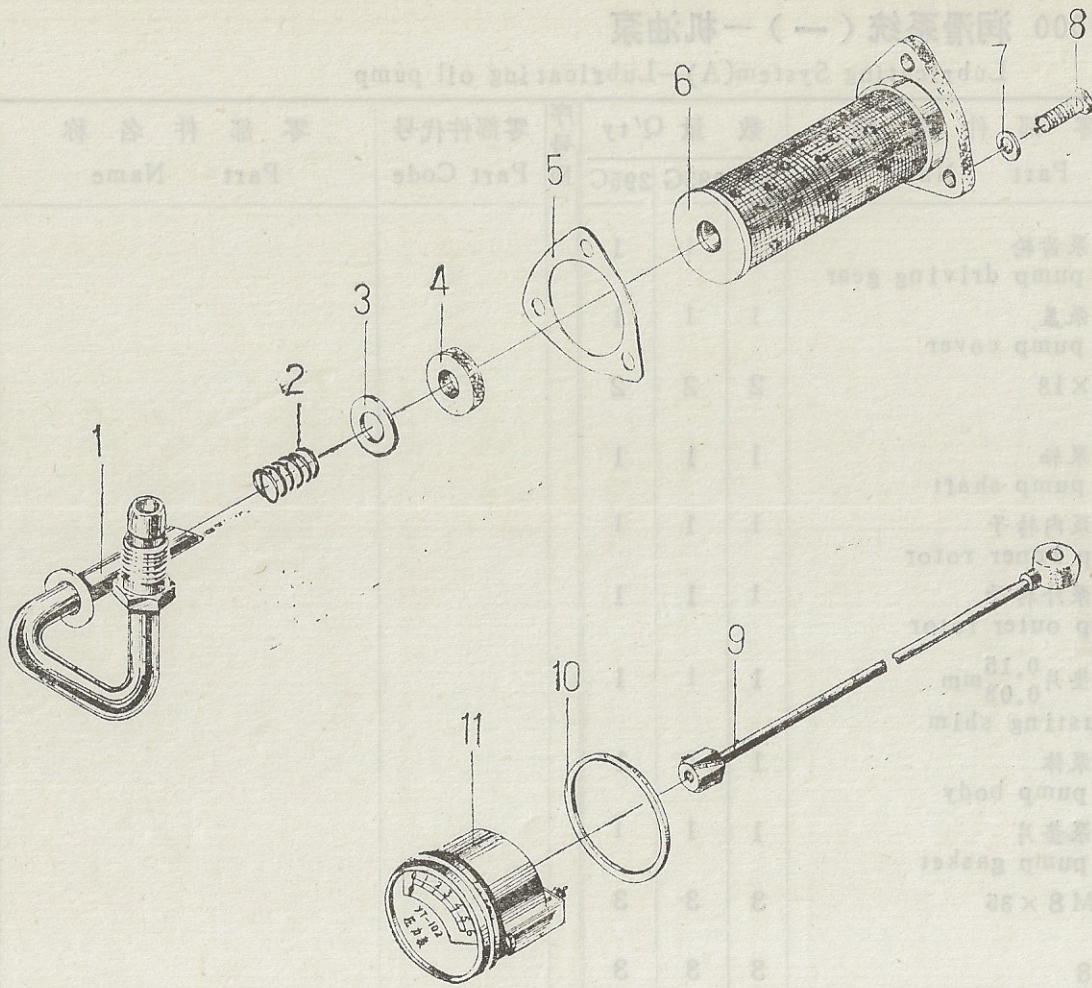
Label System (B)—Oil strainer and pressure gauge (for tractor and stationary use)



图16 295—09000 潤滑系統(三)——粗濾器及機油表(船用型)

Fig.16 295-09000 Lubricating System(C)
—Oil strainer and pressure gauge
(for marine use)

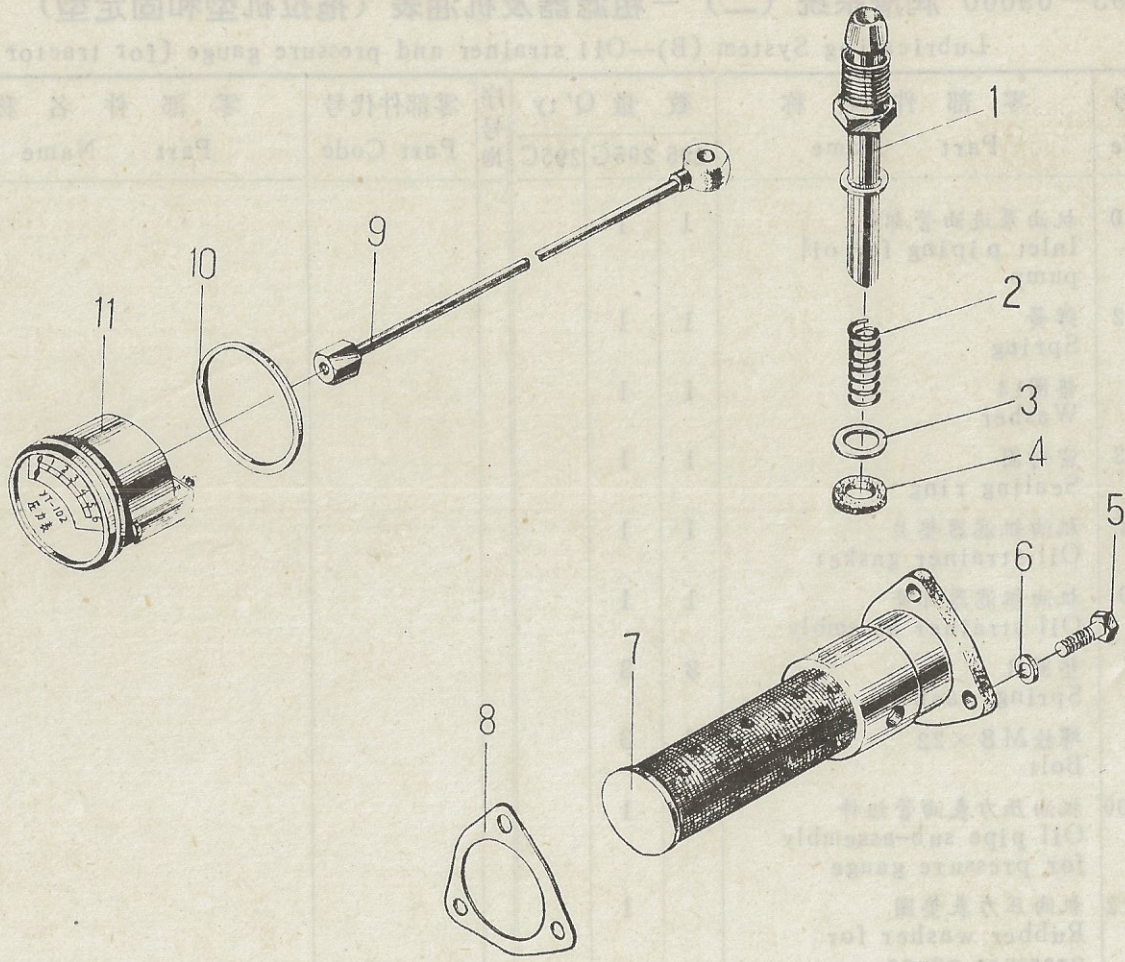

图17 机0810—0000 机油滤清器总成

Fig.17 J 0310-0000 Lubricating Oil Filter Assembly



图 18 295—10000 燃油管路(拖拉机型)
 Fig.18 295—10000 Fuel piping(for tractor use)

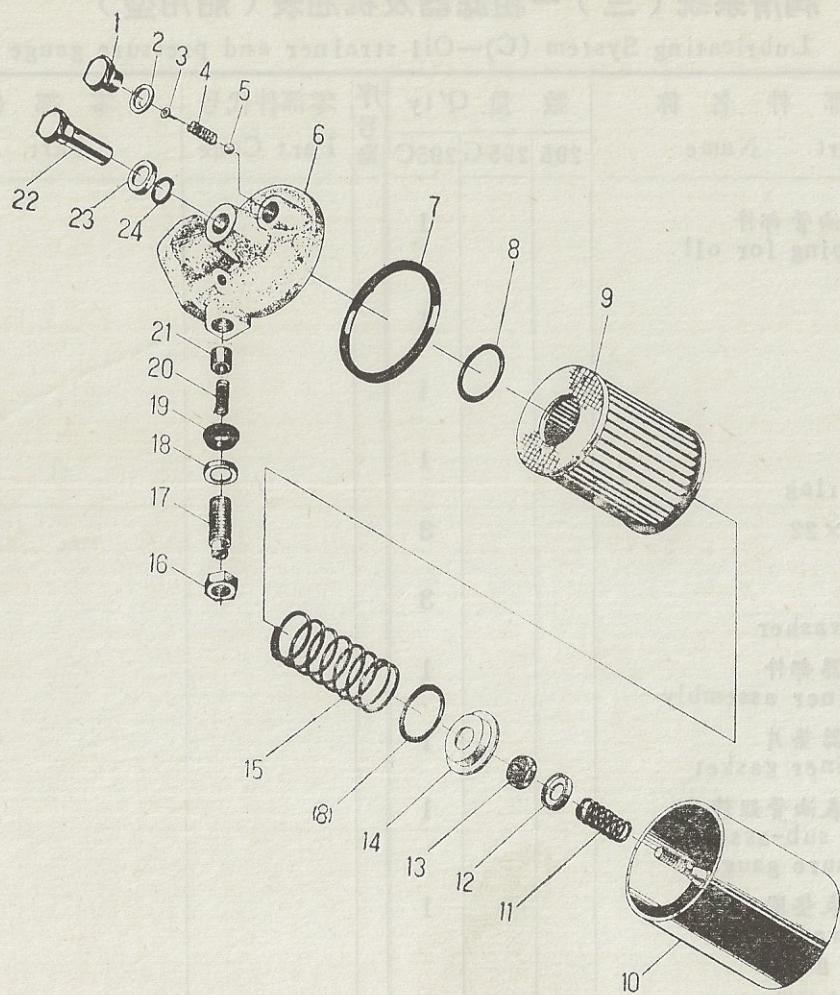

图 19 295G—10000 燃油管路(固定型)

Fig.19 295G-10000 Fuel Piping (for stationary use)

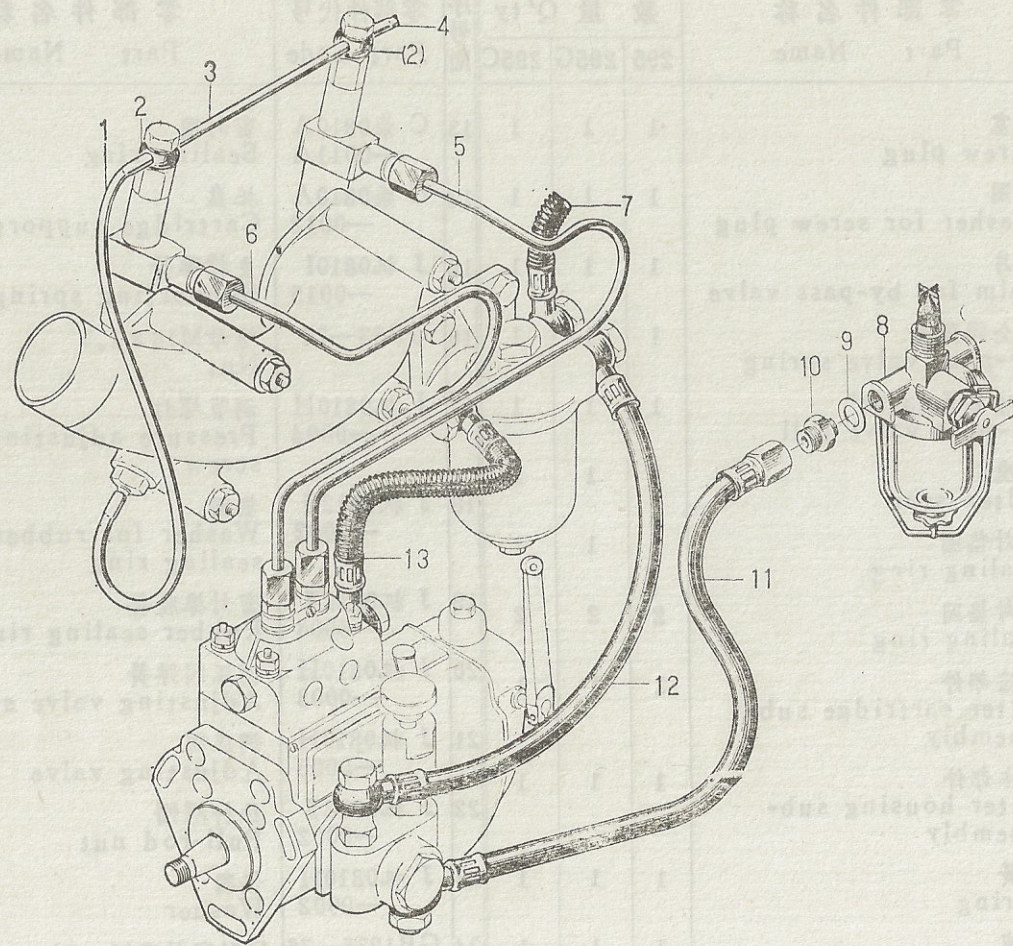

图 20 295C-10000 燃油管路(船用型)

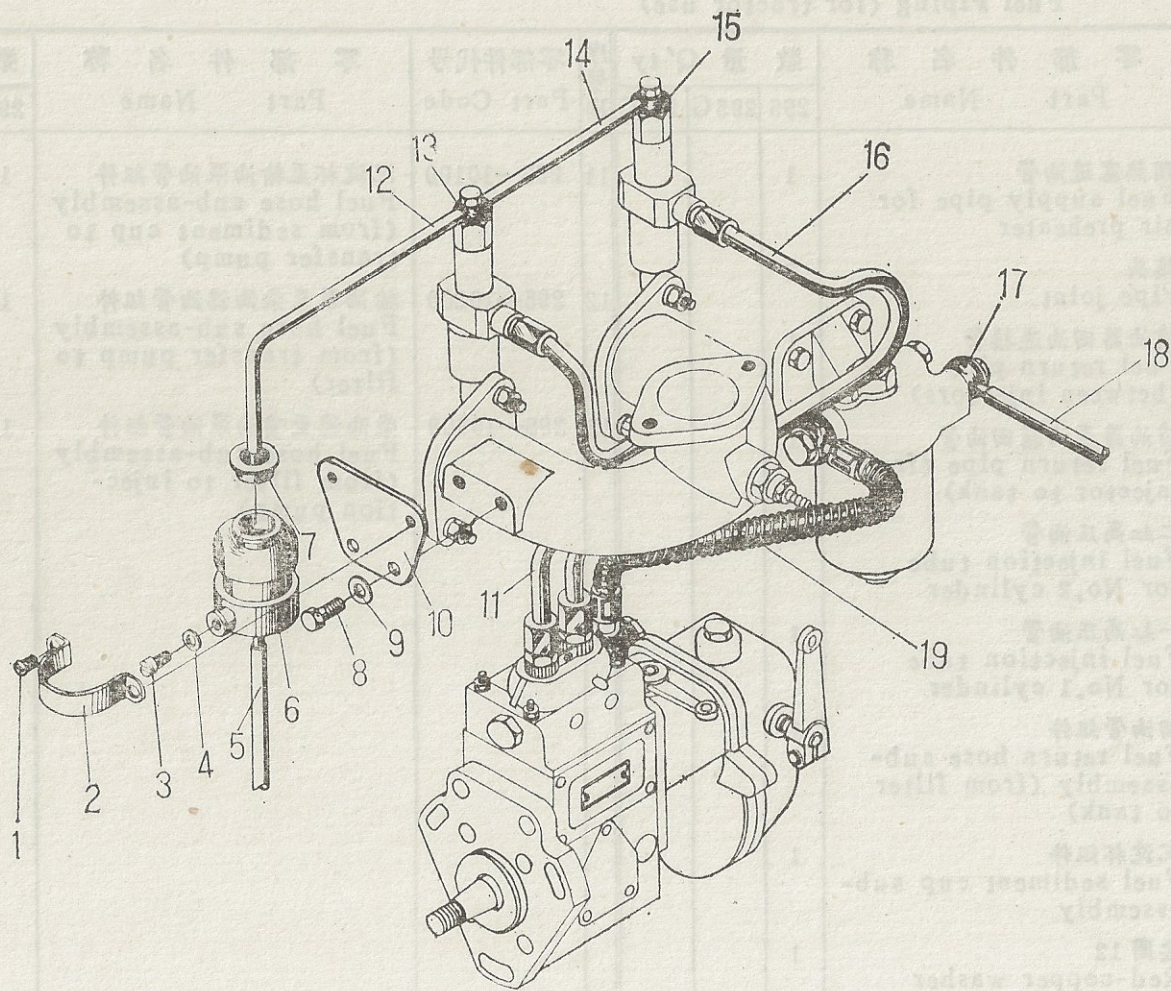
Fig.20 295C-10000 Fuel Piping (for marine use)



图21 柴0506A-0000 柴油滤清器总成
 Fig.21 C0506A-0000 Fuel Filter Assembly

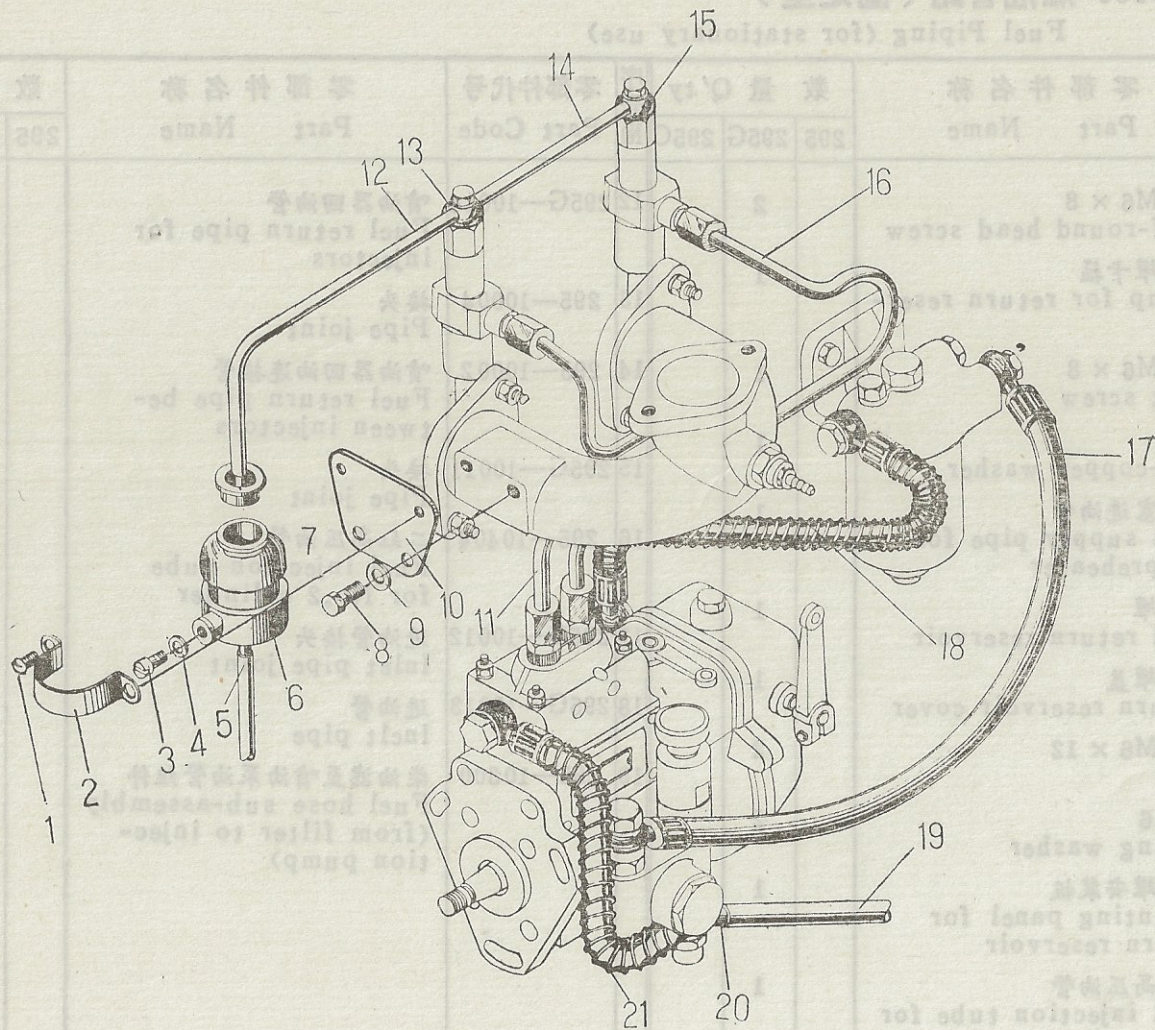

图 22 21a-00 喷油泵总成

Fig.22 21a-0 Fuel Injection Pump Assembly

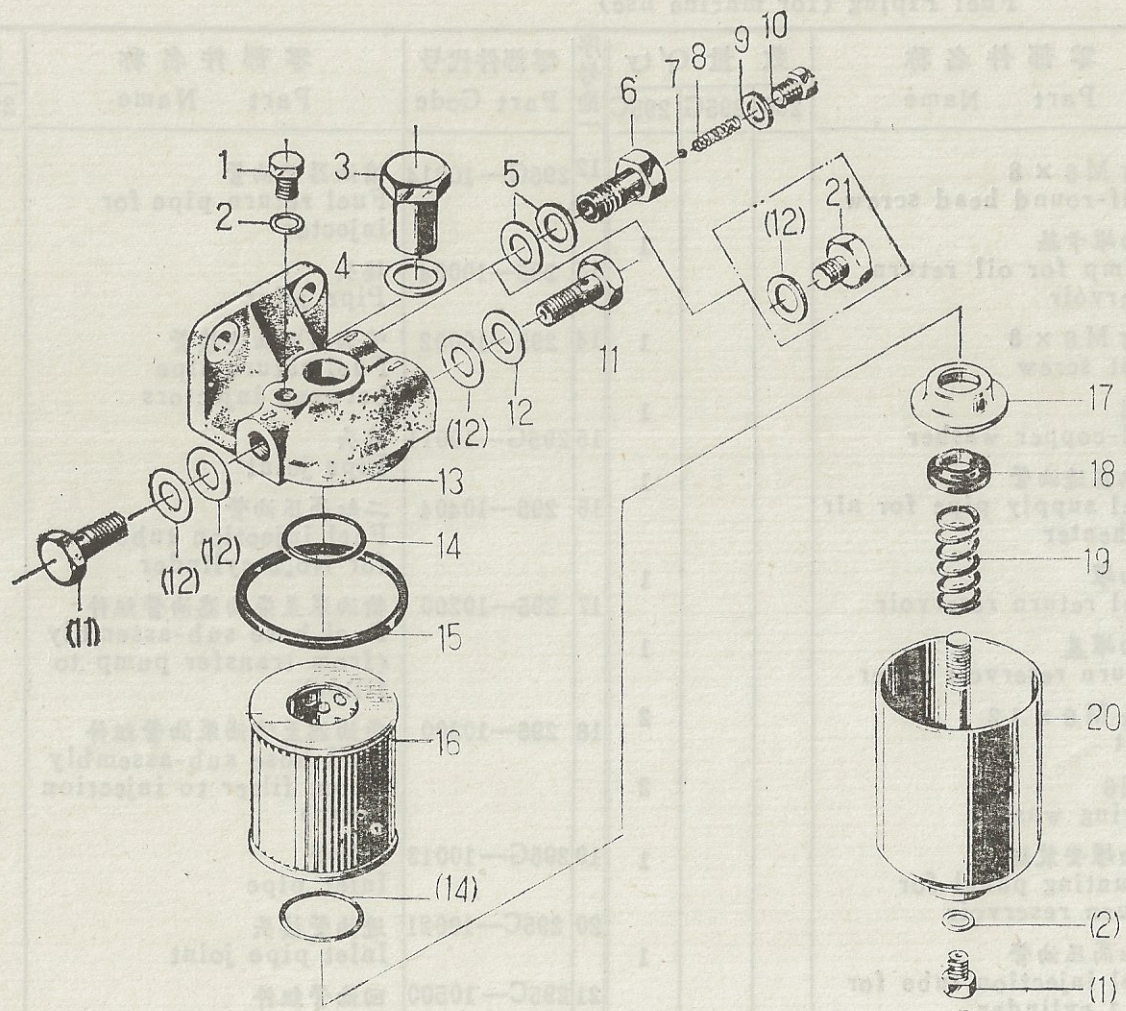

图 22 21a-00 喷油泵总成
 Fig.22 21a-00 Fuel Injection Pump Assembly

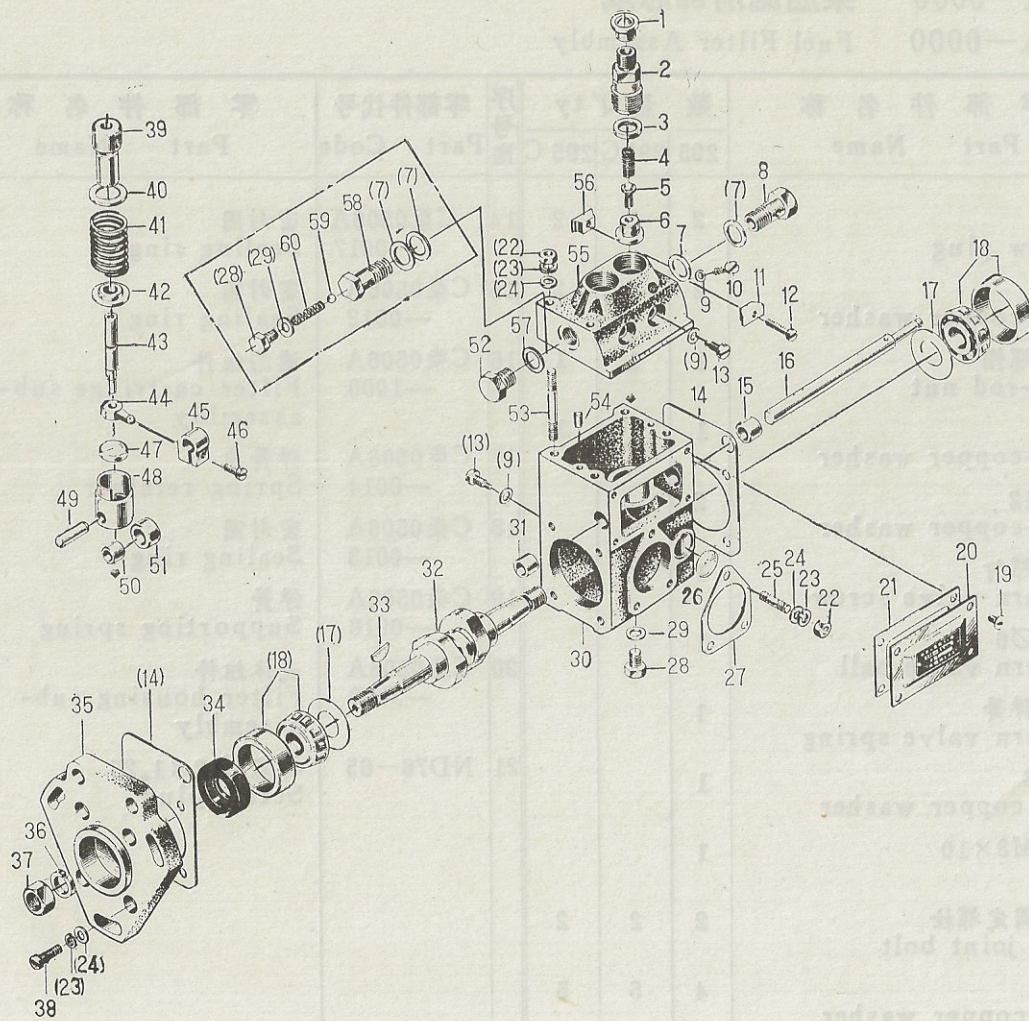

图 22 21a-00 喷油泵总成

Fig.22 21a-0 Fuel Injection Pump Assembly

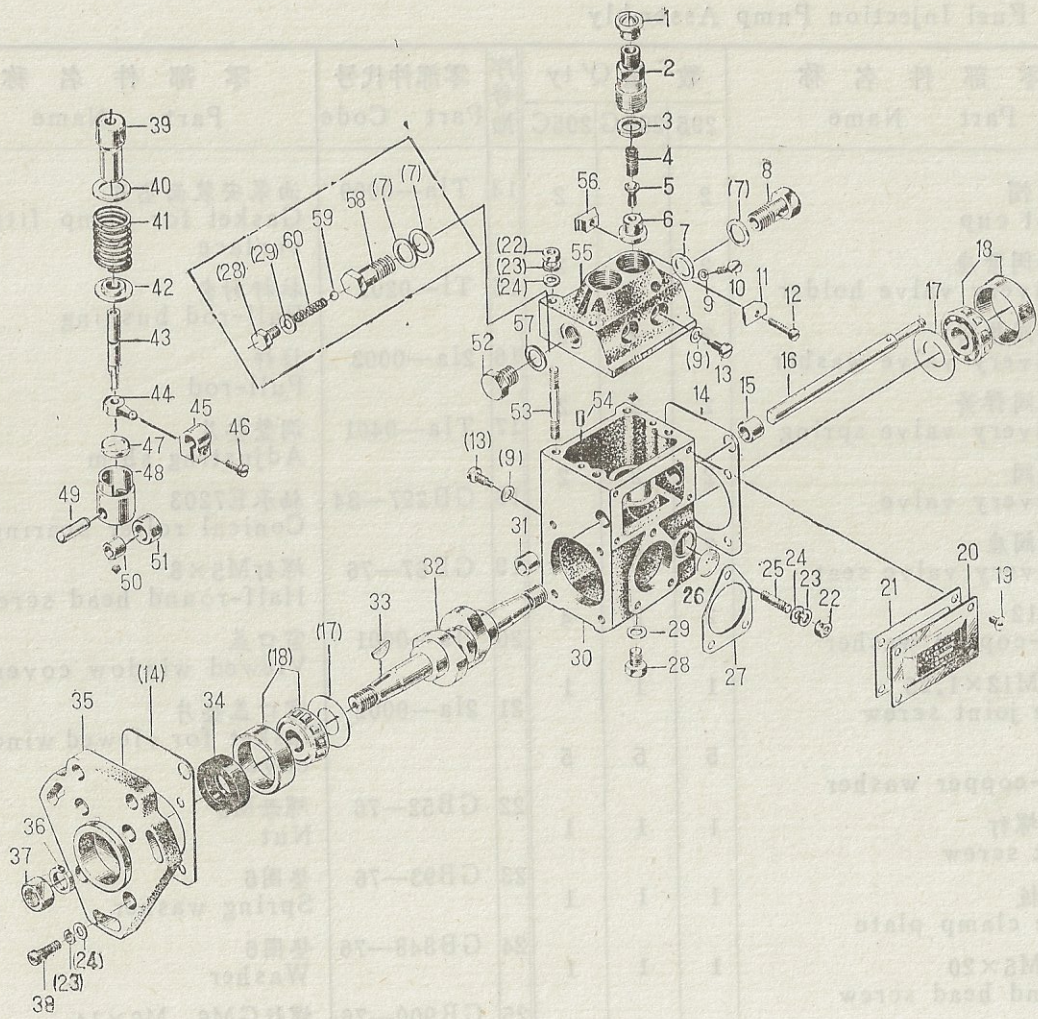

图 23 S₃-00 输油泵总成

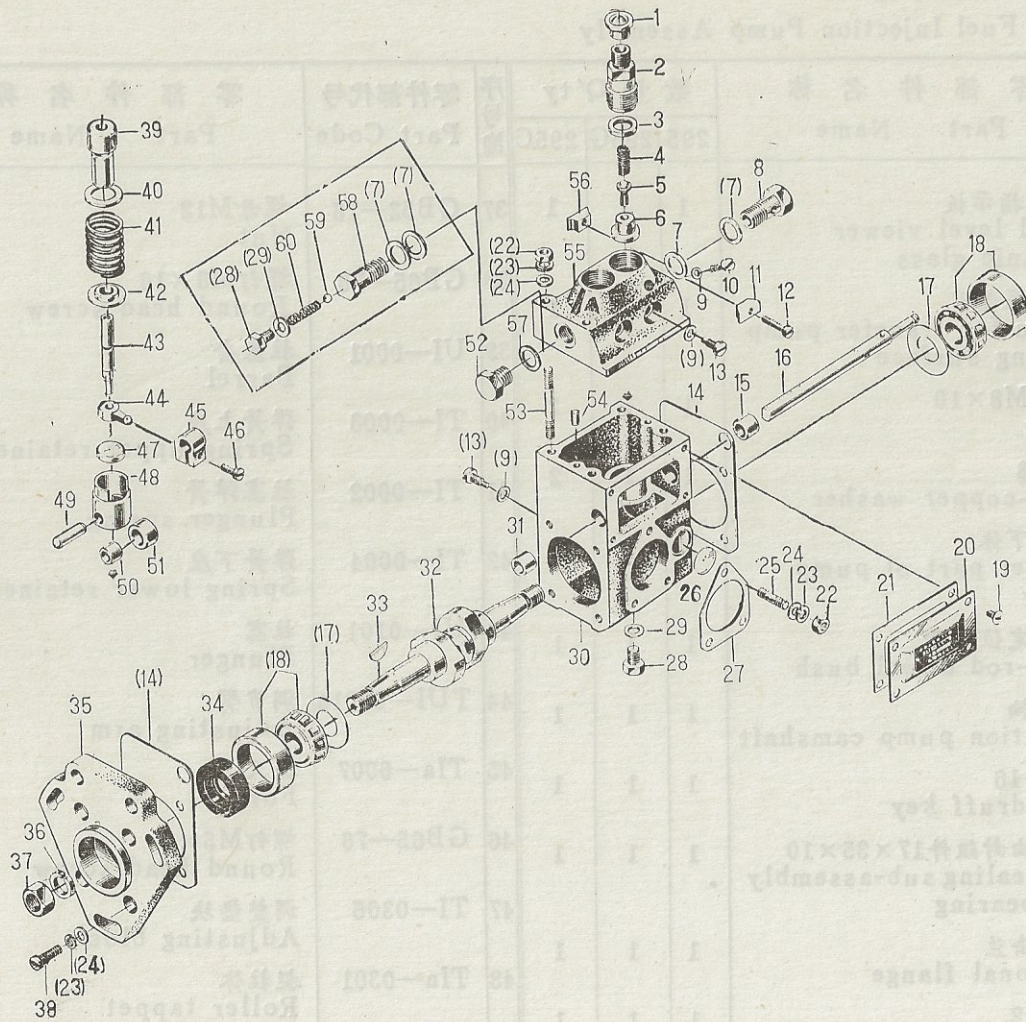
Fig.23 S₃-00 Fuel Transfer Pump Assembly



图 24 T7a-00 调速器总成
Fig.24 T7a-00 Governor Assembly

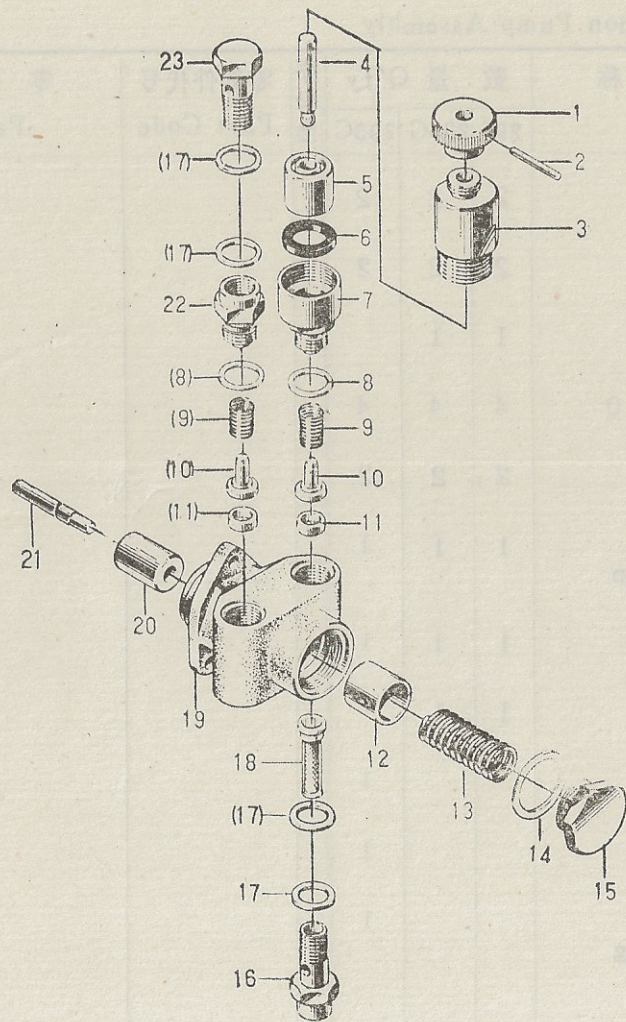

图 24 T7a-00 调速器总成
Fig.24 T7a-00 Governor Assembly

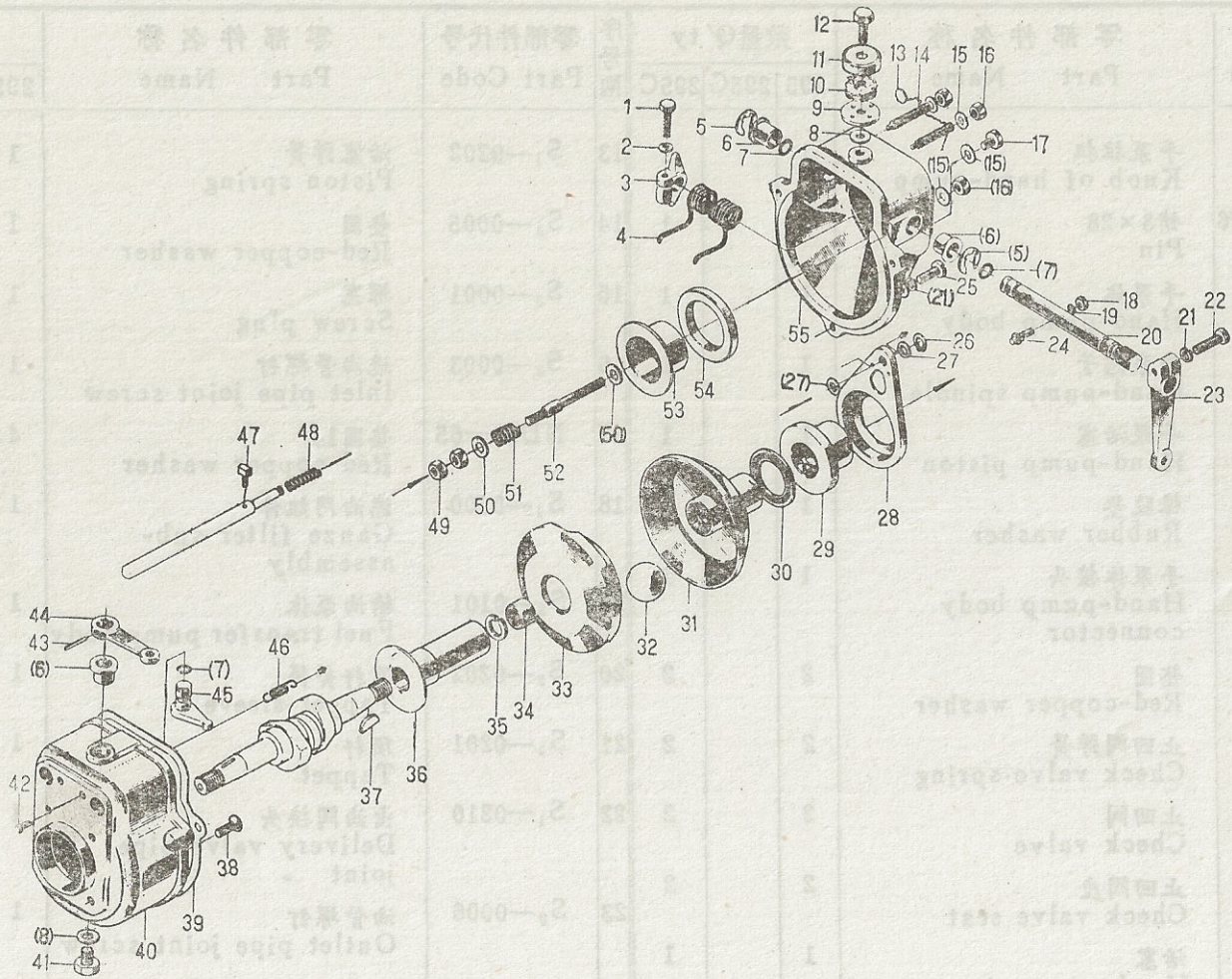

图 24 T7a-00 调速器总成
 Fig.24 T7a-00 Governor Assembly

24, T7a-00 调速器总成

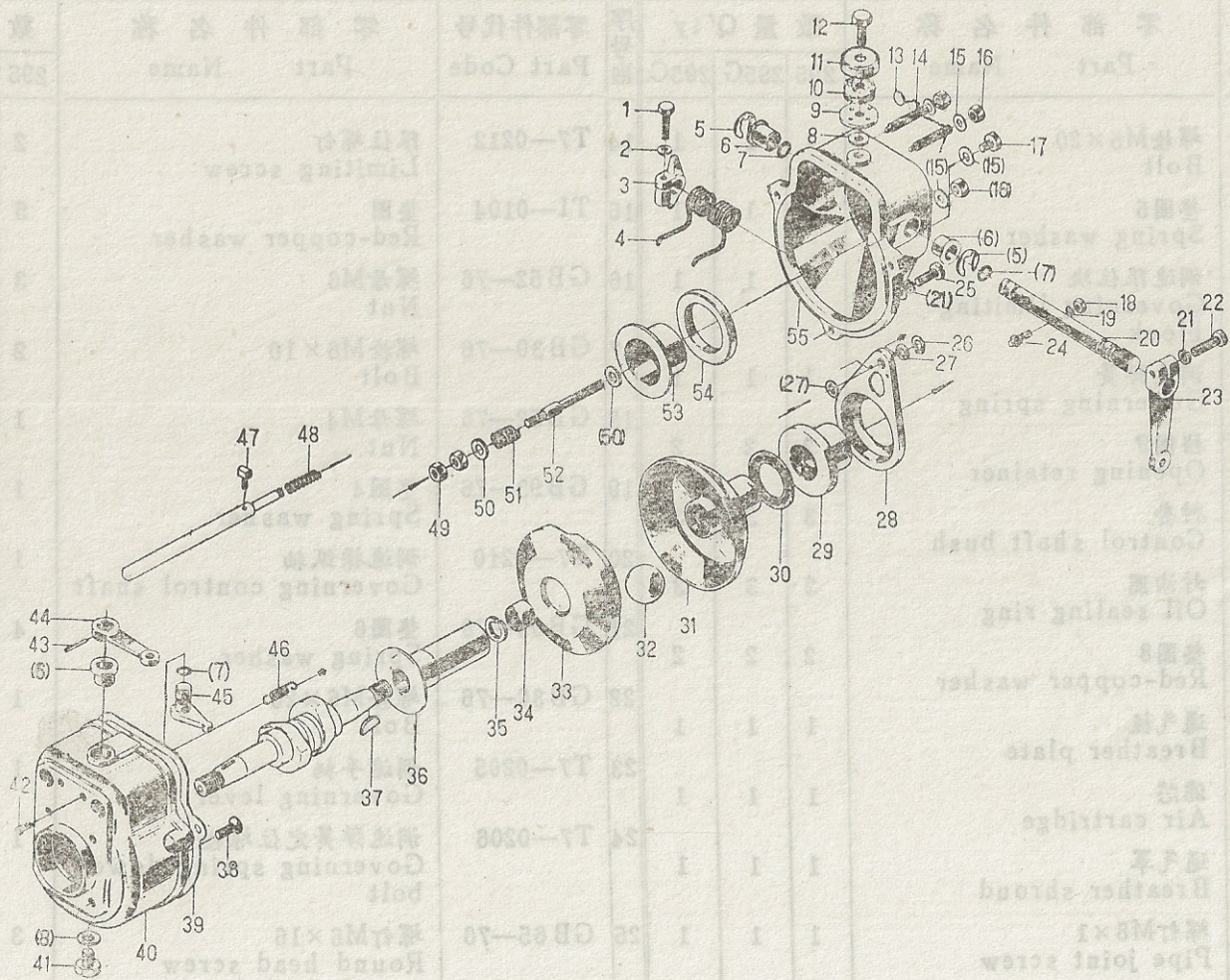
Governor Assembly

零件代号 Part Code	零件名称 Part Name	数量 Quantity	零件代号 Part Code	零件名称 Part Name	数量 Quantity
T7a-0201	调速器总成	1	T7a-0201	调速器总成	1
T7a-0212	Block	1	T7a-0212	Block	1
T7a-0201	Governor	1	T7a-0201	Governor	1

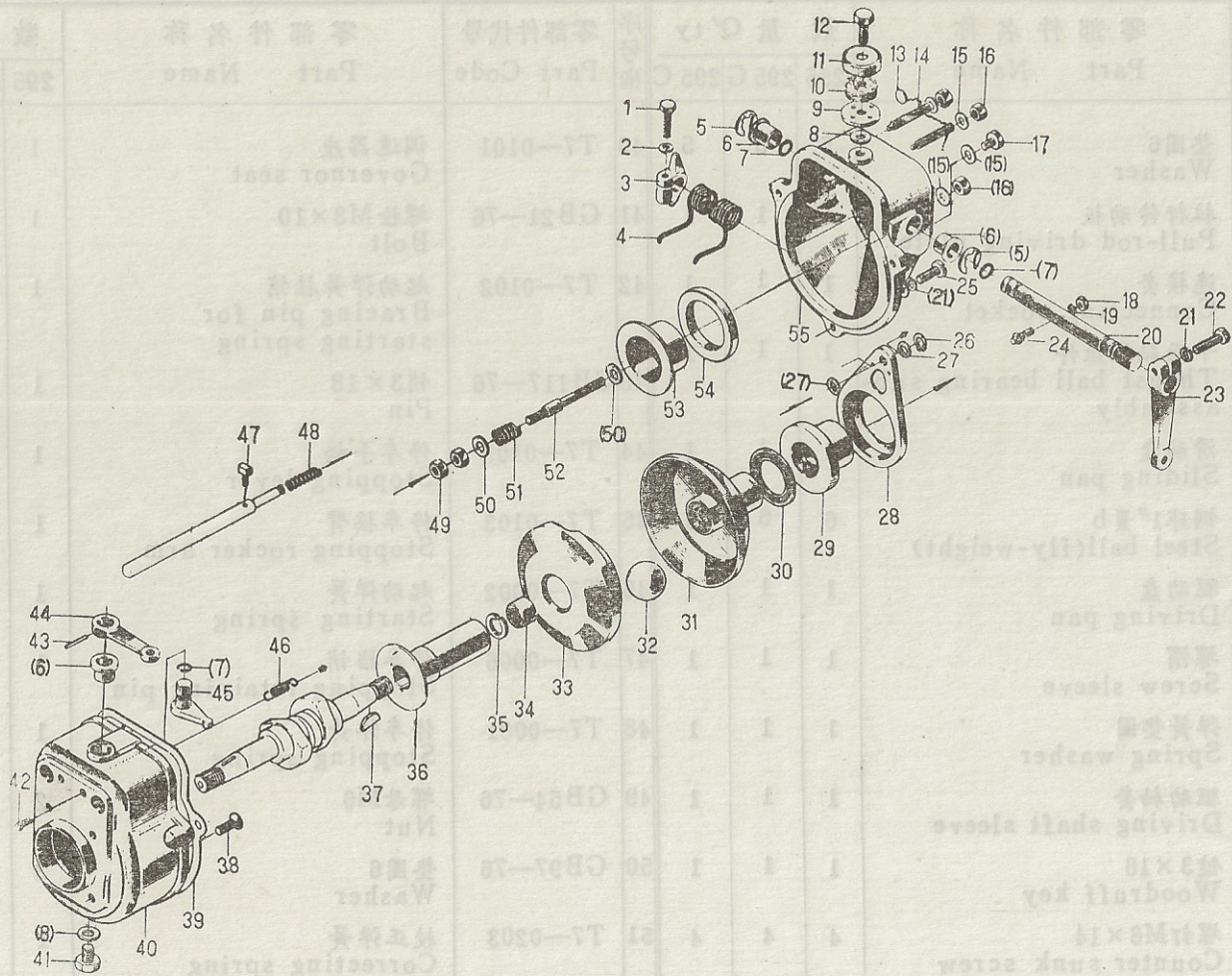

图25 P662-00 喷油器总成

Fig.25 P662-00 Fuel Injector Assembly

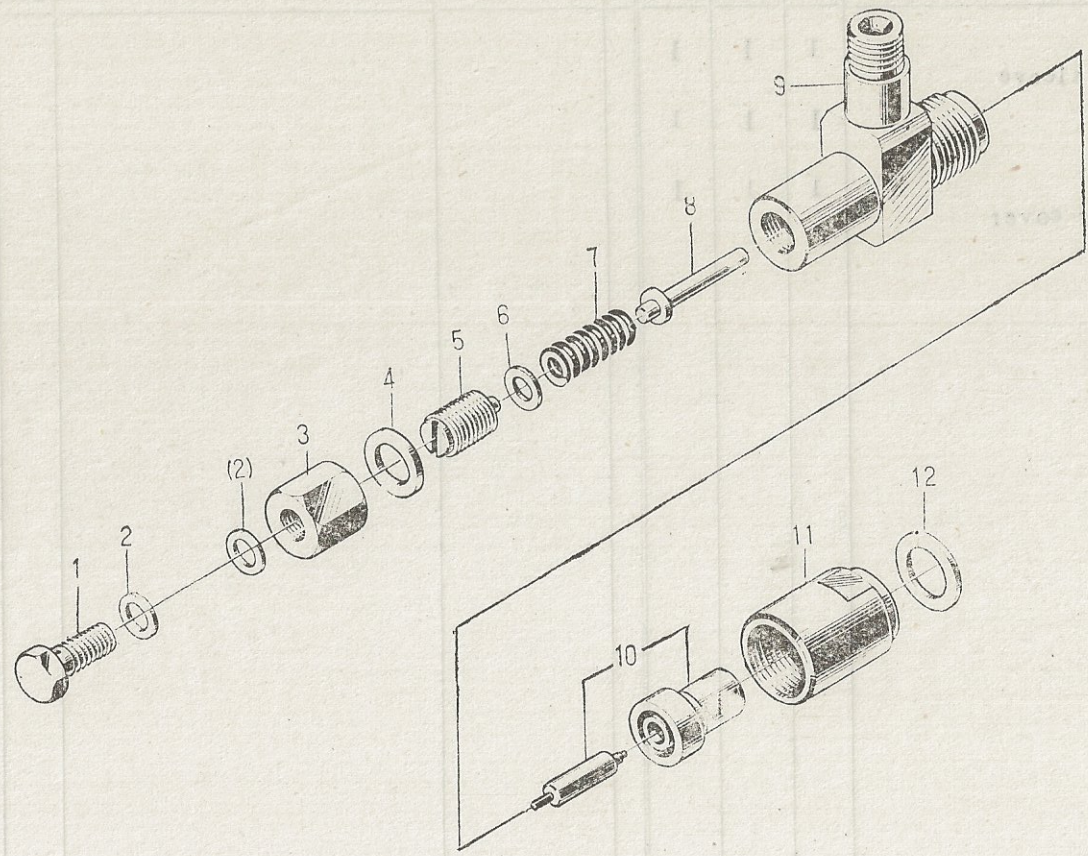

图 26 295—12000 电气起动系统

Fig.26 295-12000 Electrical Starting System

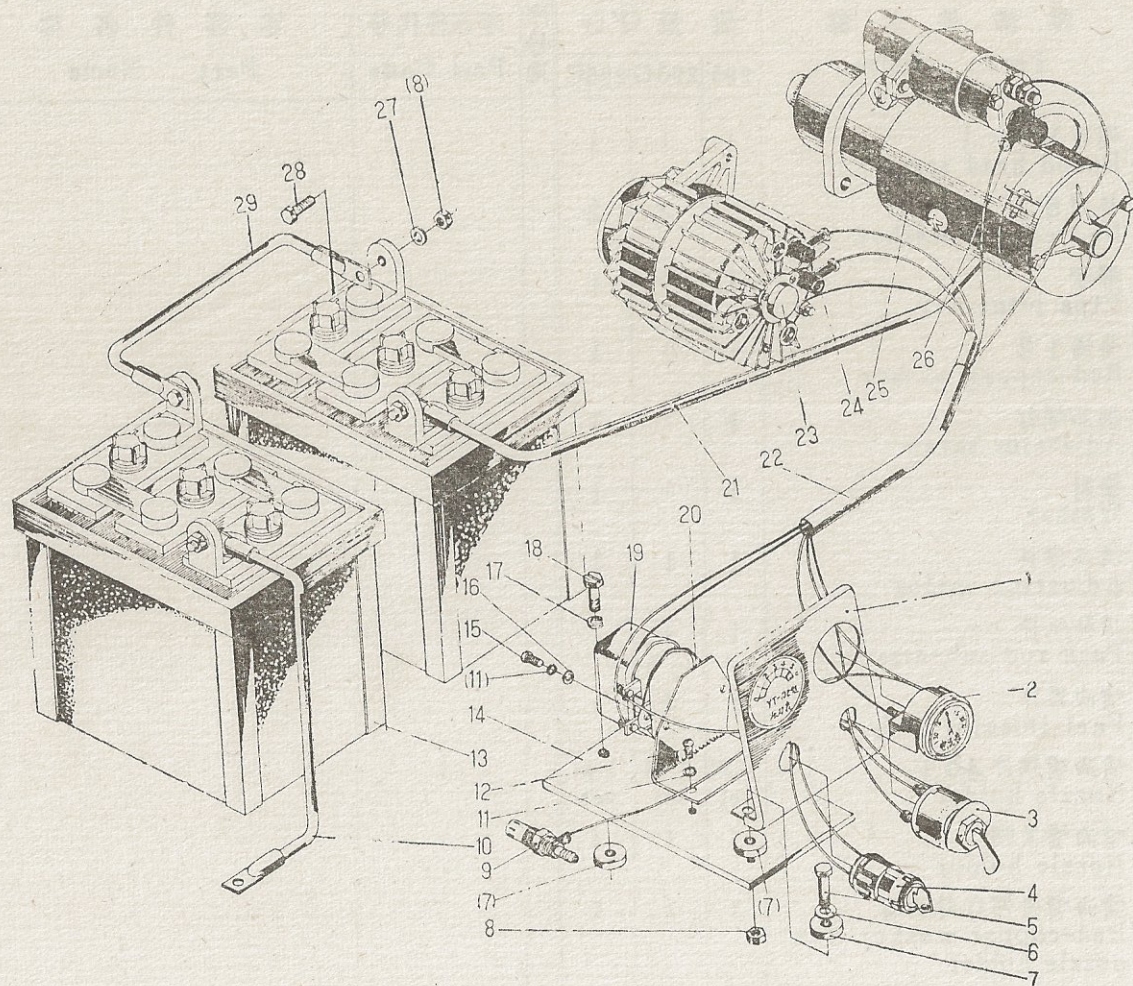
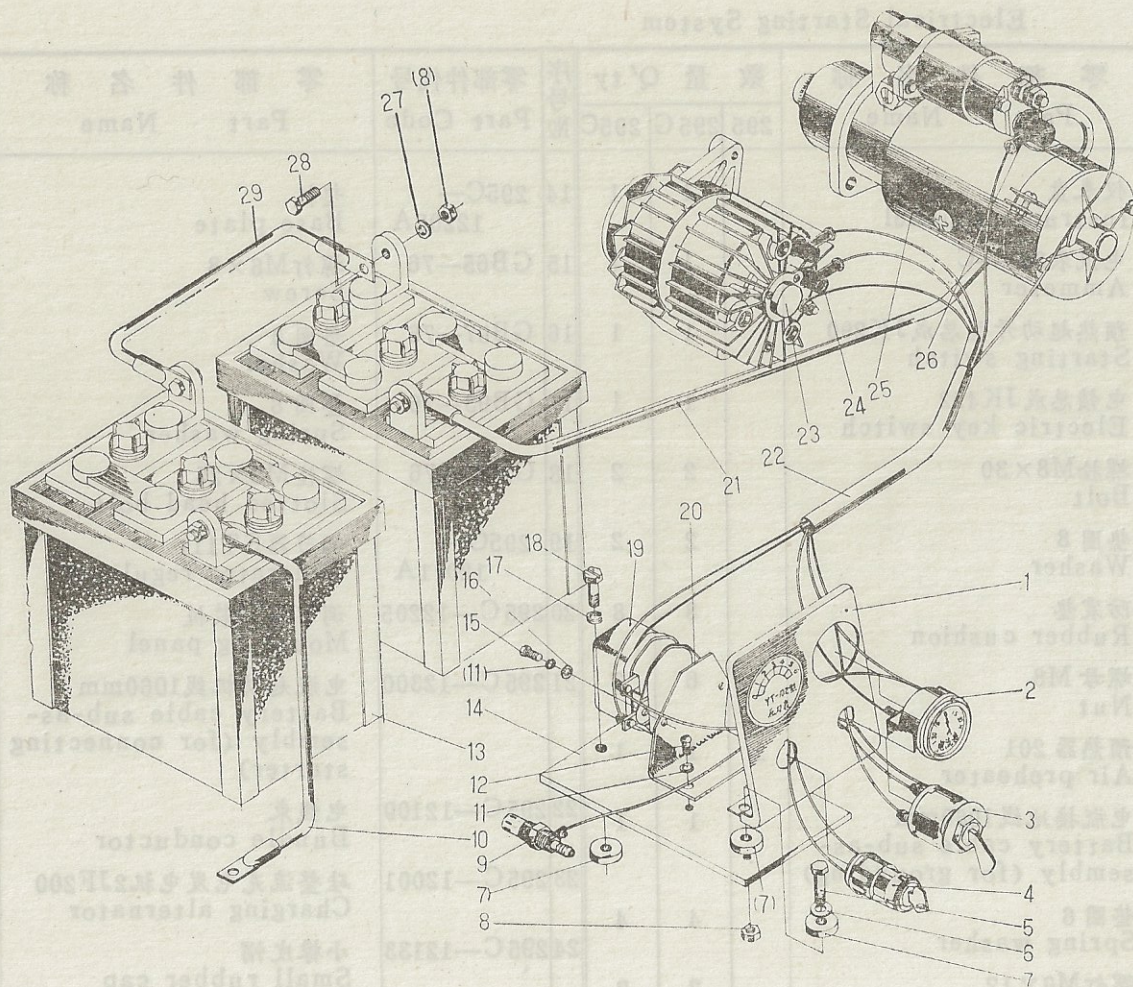

图 26 295—12000 电气起动系统

Fig.26 295-12000 Electrical Starting System